

Grundwasserstände



Diegtertal
 Zunzgen 79.P.1 Bleimatt
 Abstichpunkt: 411.69 m ü.M.
 OK Terrain: 411.19 m ü.M.

Amt für Umweltschutz und Energie
Kanton Basel-Landschaft
 Koordinaten: 627970.69 / 254848.98

2008	Januar	Februar	März	April	Mai	Juni	Juli	August	September	Oktober	November	Dezember	
1	402.89	403.30	402.45	403.45	404.59 +	402.33 +	400.70	400.64 -	400.86	402.97	404.70	402.99	1
2	402.88	403.31	402.42	403.38	404.42	402.16	400.74	400.65	400.85	402.81	404.71 +	402.85	2
3	402.83	403.38	402.40 -	403.29	404.22	402.26	400.71	400.66	400.85	402.90	404.62	402.74	3
4	402.76	403.41	402.45	403.19	404.06	402.08	400.70	400.67	400.85	402.71	404.52	402.59 -	4
5	402.70	403.44 +	402.48	403.08	403.83	402.26	400.68	400.69	400.84	402.74	404.53	402.59 -	5
Tagesmittel													
6	402.69 -	403.43	402.53	403.00	403.65	402.07	400.68	400.70	400.84	402.65	404.47	402.61	6
7	402.82	403.42	402.58	402.92	403.72	402.23	400.68	400.71	400.84	402.65	404.11	402.70	7
8	403.16	403.39	402.58	402.89	403.76	401.99	400.67	400.73	400.83	402.62	404.02	402.78	8
9	403.36	403.36	402.47	402.84 -	403.68	402.02	400.67	400.74	400.83	402.58	403.90	403.22	9
10	403.45	403.29	402.45	403.08	403.62	401.97	400.68	400.76	400.83	402.52	403.78	403.40	10
11	403.47	403.27	402.54	403.90	403.51	401.76	400.68	400.77	400.82 -	402.42	403.70	403.17	11
12	403.47	403.26	402.63	404.42	403.49	401.58	400.69	400.78	400.82 -	402.29	403.63	403.20	12
13	403.44	403.25	402.98	404.57	403.38	401.78	400.73	400.80	401.19	402.20	403.54	403.21	13
14	403.44	403.22	403.40	404.54	403.27	401.58	400.90 +	400.81	402.31	402.19	403.45	403.08	14
Max. +	403.44	403.18	403.68	404.48	403.24	401.70	400.75	400.83	403.47	402.07	403.36	403.05	15
16	403.48	403.11	403.82	404.45	403.16	401.53	400.74	400.84	403.98	401.87	403.26	403.15	16
17	403.49	403.02	403.90	404.42	403.12	401.72	400.73	400.86	404.09 +	401.87	403.21	403.22	17
18	403.48	402.93	403.95	404.34	403.13	401.54	400.72	400.87	403.95	401.70	403.18	403.26	18
19	403.47	402.92	403.98	404.20	403.15	401.74	400.71	400.88	403.71	401.71	403.15	403.27	19
Min. -	403.45	402.90	403.98	404.08	403.14	401.54	400.69	400.90	403.69	401.66	403.11	403.43	20
21	403.45	402.87	404.00	403.99	403.12	401.32	400.69	400.91 +	403.47	401.66	403.07	403.84	21
22	403.40	402.83	404.20	404.45	403.06	401.12	400.68	400.90	403.55	401.71	403.04	404.39	22
23	403.56 +	402.76	404.28	405.53	403.00	400.96	400.67	400.89	403.38	401.65 -	403.01 -	404.77	23
24	403.43	402.65	404.30 +	405.80 +	402.91	400.84	400.66	400.89	403.47	401.97	403.02	404.80 +	24
25	403.45	402.61	404.29	405.72	402.86	400.74	400.65	400.88	403.27	401.91	403.16	404.71	25
26	403.46	402.58	404.17	405.52	402.80	400.67	400.63	400.88	403.33	402.02	403.23	404.62	26
27	403.38	402.56	403.99	405.31	402.76	400.65	400.60	400.87	403.15	401.93	403.26	404.52	27
28	403.37	402.55	403.85	405.16	402.60	400.64 -	400.59 -	400.87	402.93	402.06	403.27	404.44	28
29	403.38	402.50 -	403.72	405.04	402.57	400.64 -	400.61	400.87	403.01	402.61	403.24	404.32	29
30	403.36		403.61	404.84	402.43 -	400.65	400.62	400.86	402.87	403.83	403.17	404.19	30
31	403.33		403.52		402.60		400.63	400.86		404.50 +		403.97	31
Monatsmittel	403.28	403.06	403.34	404.20 +	403.32	401.54	400.69 -	400.81	402.30	402.35	403.61	403.52	
Maximum	403.66	403.54	404.35	405.98 +	404.71	402.51	400.90 -	400.91	404.11	404.76	404.80	404.87	
Datum	23.01	05.02	24.03	24.04	01.05	01.06	14.07	21.08	18.09	31.10	02.11	24.12	
Amplitude	1.21	1.21	2.14	3.33	2.45	1.86	0.31	0.27	3.29	3.11	2.01	2.52	
Jahr 2008	Mittel	402.66 m ü.M.		Maximum	405.98 (24.Apr)		Minimum	400.59 (28.Jul)		Amplitude	5.39 m		

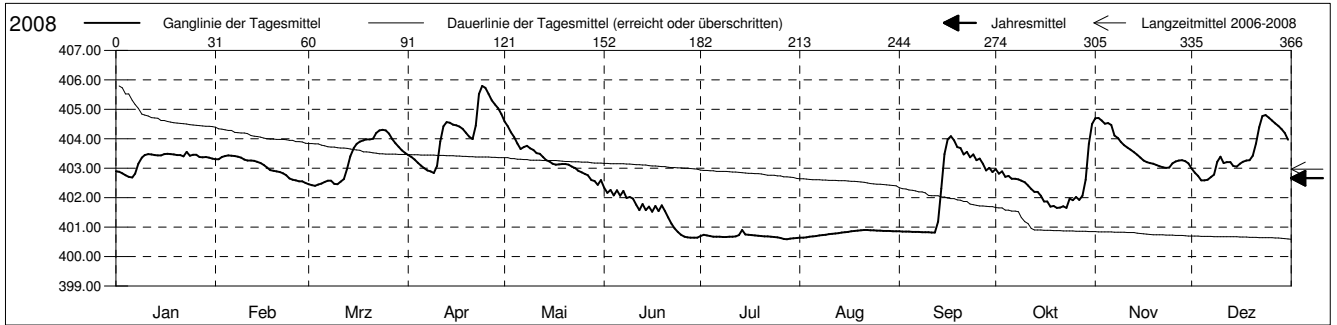

Periode	2006 - 2008												
Monatsmittel	403.57	403.62	403.67 +	403.56	402.69	402.51	402.17 -	402.32	402.73	402.20	402.75	403.64	
Maximum	404.22	404.62	404.96	405.98 +	404.71	404.35	404.17	405.44	404.11 -	404.76	404.80	405.57	
Jahr	2007	2007	2007	2008 +	2008	2007	2007	2007	2008	2008	2008	2006	
Minimum	402.45 +	402.33	402.20	401.66	401.64	400.64	400.59 -	400.64	400.82	401.64	401.64	401.65	
Jahr	2008	2008	2008	2007	2007	2008	2008	2008	2008	2007	2007	2007	
Amplitude	1.21	1.21	2.14	3.33 +	2.45	1.86	0.90 -	2.87	3.29	3.11	2.01	2.91	
Jahr	2008	2008	2008	2008	2008	2008	2007	2007	2008	2008	2008	2007	
Periode	Mittel	402.97 m ü.M.		Maximum	405.98 (24.Apr 2008)		Minimum	400.59 (28.Jul 2008)		Amplitude	5.39 m		

Darstellung der letzten 3 Jahre

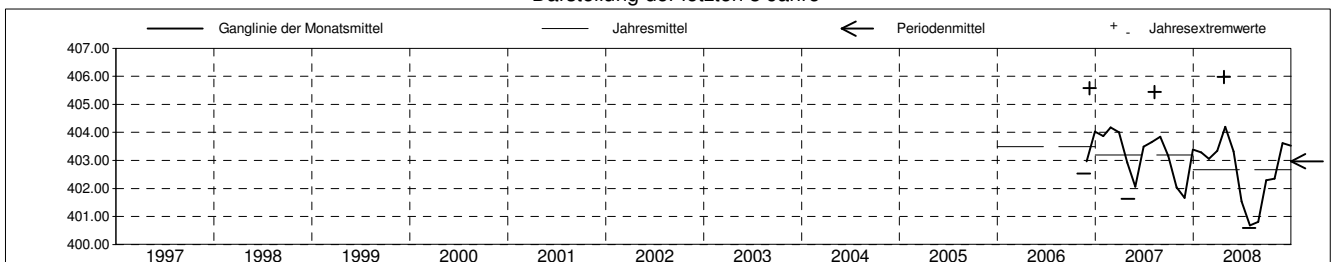

Grundwassertemperatur



Diegtertal

Zunzgen

Abstichpunkt:

OK Terrain:

79.P.1

411.69

411.19

Bleimatt

m ü.M.

m ü.M.

Amt für Umweltschutz und Energie

Kanton Basel-Landschaft

Koordinaten: 627970.69 / 254848.98

2008	Januar	Februar	März	April	Mai	Juni	Juli	August	September	Oktober	November	Dezember	
1	11.8 -	11.8 -	11.9 +	11.7	11.5 +	11.3 +	11.1 +	11.0 +	11.0 -	11.1 -	12.1 +	11.5 -	1
2	11.8 -	11.9 +	11.9 +	11.7	11.5 +	11.3 +	11.1 +	11.0 +	11.0 -	11.1 -	11.5	11.5 -	2
3	11.8 -	11.9 +	11.9 +	11.8 +	11.5 +	11.3 +	11.1 +	11.0 +	11.0 -	11.1 -	11.3 -	11.5 -	3
4	11.9 +	11.8 -	11.9 +	11.8 +	11.5 +	11.3 +	11.0 -	11.0 +	11.0 -	11.1 -	11.3 -	11.6	4
5	11.9 +	11.8 -	11.9 +	11.8 +	11.5 +	11.3 +	11.0 -	11.0 +	11.0 -	11.1 -	11.3 -	11.6	5
Tagesmittel													
6	11.9 +	11.8 -	11.9 +	11.8 +	11.5 +	11.3 +	11.0 -	11.0 +	11.0 -	11.2	11.4	11.5 -	6
7	11.8 -	11.8 -	11.9 +	11.8 +	11.4	11.3 +	11.0 -	11.0 +	11.0 -	11.1 -	11.3 -	11.5 -	7
8	11.8 -	11.8 -	11.9 +	11.8 +	11.4	11.2	11.0 -	11.0 +	11.0 -	11.1 -	11.3 -	11.5 -	8
9	11.8 -	11.9 +	11.9 +	11.8 +	11.4	11.2	11.0 -	11.0 +	11.0 -	11.2	11.3 -	11.5 -	9
10	11.8 -	11.9 +	11.9 +	11.7	11.4	11.2	11.0 -	11.0 +	11.0 -	11.2	11.3 -	11.5 -	10
11	11.8 -	11.8 -	11.9 +	11.6	11.4	11.2	11.0 -	11.0 +	11.0 -	11.2	11.3 -	11.5 -	11
12	11.8 -	11.8 -	11.9 +	11.4	11.4	11.2	11.0 -	11.0 +	11.0 -	11.2	11.3 -	11.5 -	12
13	11.8 -	11.8 -	11.8	11.4	11.4	11.2	11.0 -	11.0 +	11.0 -	11.2	11.3 -	11.5 -	13
14	11.8 -	11.8 -	11.8	11.5	11.4	11.2	11.0 -	11.0 +	11.1 +	11.2	11.3 -	11.5 -	14
Max. +	11.8 -	11.9 +	11.8	11.6	11.4	11.2	11.0 -	11.0 +	11.1 +	11.2	11.3 -	11.5 -	15
16	11.8 -	11.9 +	11.8	11.7	11.4	11.2	11.0 -	11.0 +	11.1 +	11.2	11.4	11.5 -	16
17	11.8 -	11.9 +	11.8	11.7	11.4	11.2	11.0 -	11.0 +	11.1 +	11.2	11.4	11.5 -	17
18	11.8 -	11.9 +	11.8	11.7	11.4	11.2	11.0 -	11.0 +	11.1 +	11.2	11.4	11.5 -	18
19	11.8 -	11.9 +	11.7 -	11.7	11.4	11.2	11.0 -	11.0 +	11.1 +	11.2	11.4	11.5 -	19
Min. -	11.8 -	11.9 +	11.7 -	11.6	11.4	11.1 -	11.0 -	11.0 +	11.1 +	11.2	11.4	11.5 -	20
21	11.8 -	11.9 +	11.7 -	11.6	11.4	11.1 -	11.0 -	11.0 +	11.1 +	11.2	11.4	11.8	21
22	11.8 -	11.9 +	11.7 -	11.5	11.3 -	11.1 -	11.0 -	11.0 +	11.1 +	11.3	11.4	12.1 +	22
23	11.8 -	11.9 +	11.7 -	11.1	11.3 -	11.1 -	11.0 -	11.0 +	11.1 +	11.3	11.4	12.1 +	23
24	11.8 -	11.9 +	11.7 -	10.9	11.3 -	11.1 -	11.0 -	11.0 +	11.1 +	11.3	11.4	11.7	24
25	11.8 -	11.9 +	11.7 -	10.8 -	11.3 -	11.1 -	11.0 -	11.0 +	11.1 +	11.3	11.4	11.6	25
26	11.9 +	11.9 +	11.8	10.8 -	11.3 -	11.1 -	11.0 -	11.0 +	11.1 +	11.3	11.4	11.6	26
27	11.9 +	11.9 +	11.8	11.3	11.3 -	11.1 -	11.0 -	11.0 +	11.1 +	11.3	11.4	11.6	27
28	11.8 -	11.9 +	11.8	11.6	11.3 -	11.1 -	11.0 -	11.0 +	11.1 +	11.3	11.4	11.6	28
29	11.8 -	11.9 +	11.8	11.6	11.3 -	11.1 -	11.0 -	11.0 +	11.1 +	11.3	11.4	11.6	29
30	11.8 -	11.9 +	11.7 -	11.5	11.3 -	11.1 -	11.0 -	11.0 +	11.1 +	11.5	11.4	11.6	30
31	11.9 +		11.7 -	11.3 -	11.3 -		11.0 -	11.0 +		11.9 +		11.6	31
Monatsmittel	11.8	11.9 +	11.8	11.5	11.4	11.2	11.0 -	11.0 -	11.1	11.2	11.4	11.6	
Maximum	11.9	12.0	11.9	11.8	11.5	11.3	11.1	11.0 -	11.1	12.0	12.1	12.2 +	
Datum	04.01	24.02	01.03	03.04	01.05	01.06	01.07	01.08	14.09	31.10	01.11	22.12	
Minimum	11.7	11.8 +	11.7	10.7 -	11.3	11.1	11.0	11.0	11.0	11.1	11.3	11.5	
Datum	08.01	01.02	18.03	25.04	16.05	20.06	03.07	01.08	01.09	01.10	02.11	01.12	
Amplitude	0.2	0.2	0.2	1.1	0.2	0.2	0.1	0.0 +	0.1	0.9	0.8	0.7	
Jahr 2008	Mittel	11.4 °C		Maximum	12.2 (22.Dez)		Minimum	10.7 (25.Apr)		Amplitude		1.5 °C	

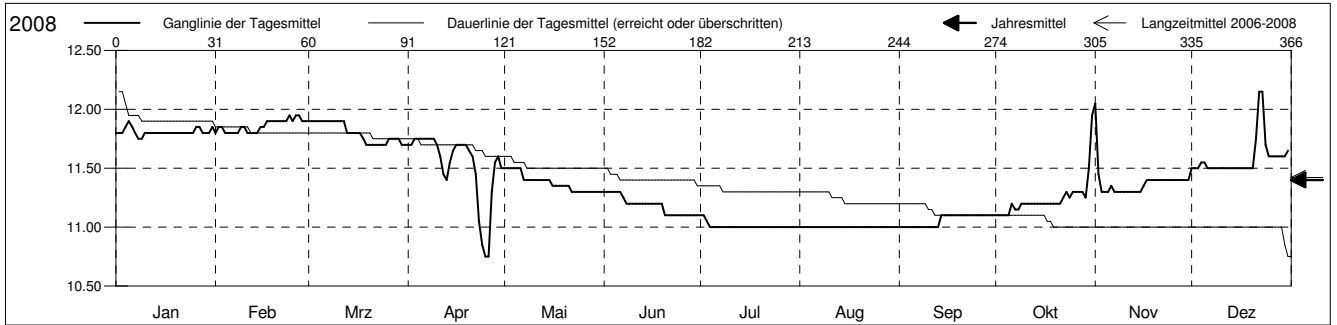

Periode	2006 - 2008												
Monatsmittel	11.7 +	11.7 +	11.7 +	11.6	11.4	11.3	11.1 -	11.1 -	11.2	11.3	11.4	11.6	
Maximum	11.9	12.0	11.9	11.8	11.5	11.4	11.3 -	11.4	11.4	12.0	12.1	12.2 +	
Jahr	2008	2008	2008	2008	2007	2007	2007	2007	2007	2008	2008	2006	
Minimum	11.4	11.6 +	11.6 +	10.7 -	11.3	11.1	11.0	11.0	11.0	11.0	11.0	11.1	
Jahr	2007	2007	2007	2008	2008	2008	2008	2008	2008	2006	2006	2006	
Amplitude	0.2	0.2	0.2	1.1 +	0.2	0.2	0.1 -	0.3	0.2	0.9	0.8	1.1 +	
Jahr	2007	2008	2007	2008	2008	2007	2007	2007	2007	2008	2008	2006	
Periode	Mittel	11.4 °C		Maximum	12.2 (10.Dez 2006)		Minimum	10.7 (25.Apr 2008)		Amplitude		1.5 °C	

Darstellung der letzten 3 Jahre

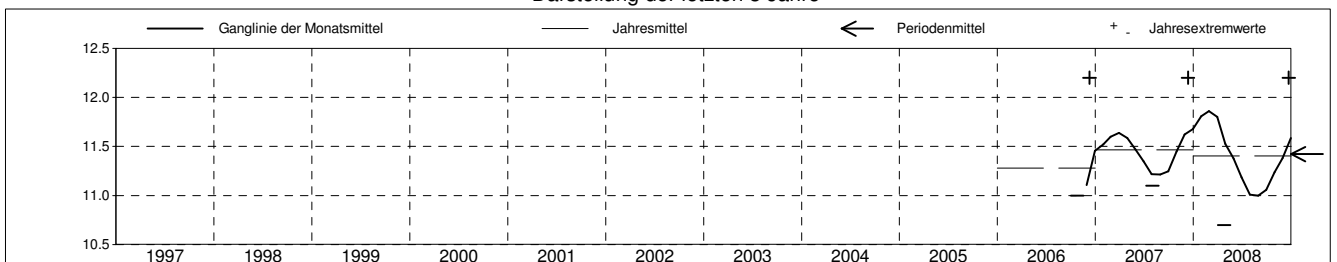

Grundwasserspiegel im Diegtertal

Station 79.P.1

Opm 214842
OK. Abstich = OK Rohr
411.69 m ü.M.

Zunzgen

OK. Terrain
411.19 m ü.M.

Bleimatt

Koordinaten: 627'970.69 / 254'848.98

Messwerte: **Grundwasserspiegel**
Temperatur

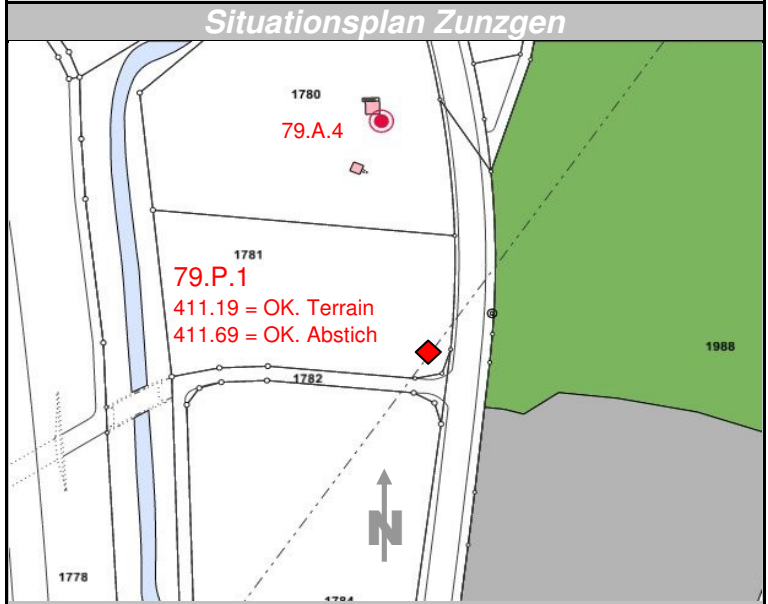
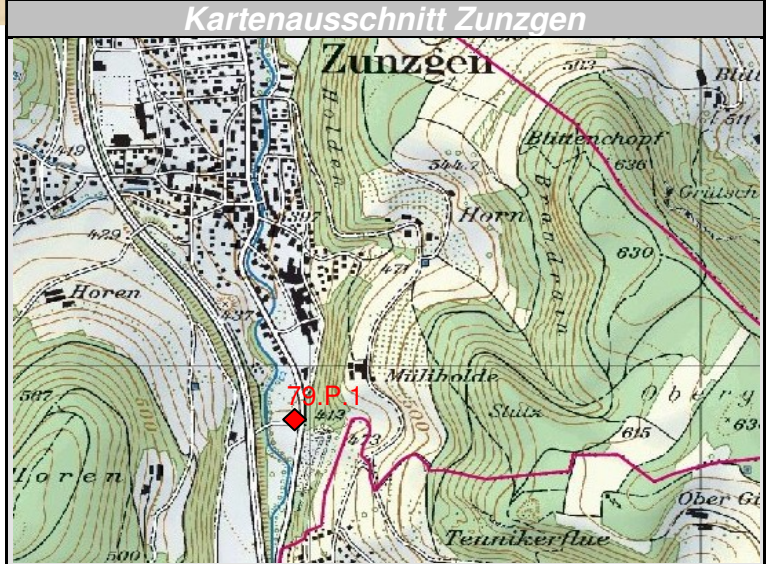
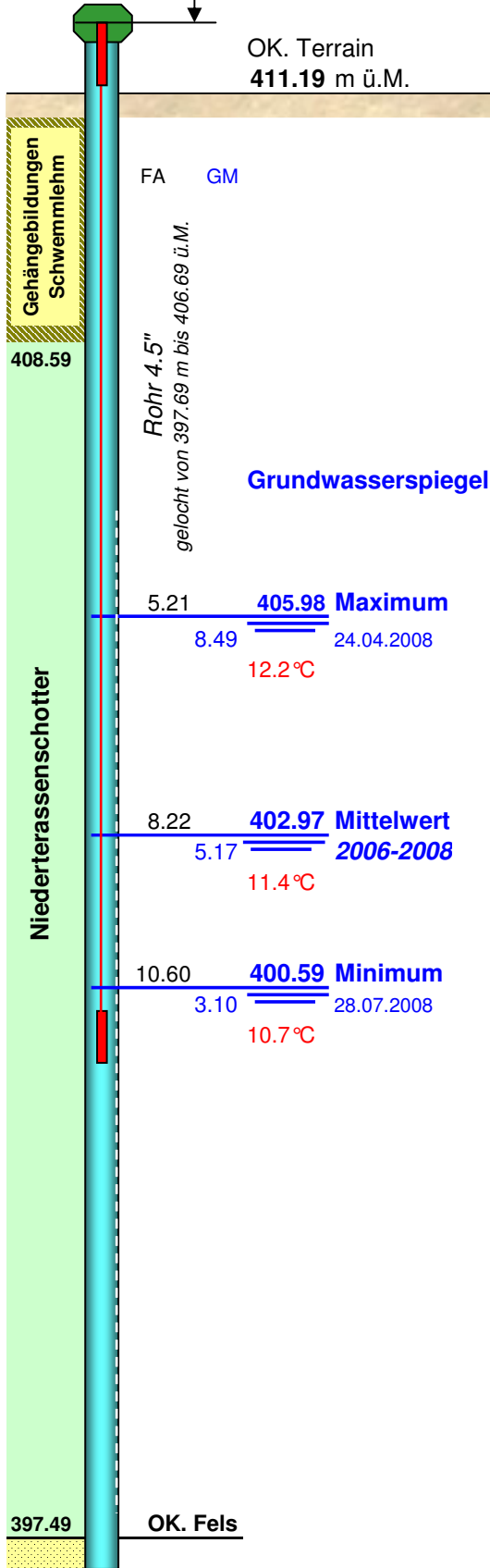

396.49 UK. Sondierung

Hauptrogenstein FA= Flurabstände GM= Grundwassermächtigkeit in m