

Grundwasserstände



Ergolzthal
 Pratteln 41.J.14 Löli - Remeli
 Abstichpunkt: 278.15 m ü.M.
 OK Terrain: 277.23 m ü.M.

Amt für Umweltschutz und Energie
 Kanton Basel-Landschaft
 Koordinaten: 620545.75 / 264047.00

2006	Januar	Februar	März	April	Mai	Juni	Juli	August	September	Oktober	November	Dezember	
1	260.58 -	260.63	260.69	263.31 -	264.84	264.83	264.50 +	263.91 -	263.97	264.29 -	264.30 +	263.94	1
2	260.61	260.61	260.69	263.38	264.83	264.84	264.49	263.92	263.97	264.35	264.27	263.93	2
3	260.65	260.59	260.68 -	263.44	264.81	264.86	264.48	263.92	263.97	264.43	264.25	263.93	3
4	260.70	260.57	260.68 -	263.50	264.80	264.87	264.45	263.92	263.96	264.48	264.24	263.93	4
5	260.74	260.55	260.68 -	263.55	264.77	264.88	264.42	263.92	263.95	264.52	264.22	263.92 -	5
Tagesmittel													
6	260.77	260.54	260.69	263.59	264.76	264.89 +	264.40	263.93	263.94	264.56	264.21	263.92 -	6
7	260.80	260.52	260.72	263.64	264.75	264.89 +	264.39	263.96	263.92	264.58	264.19	263.94	7
8	260.81	260.50	260.75	263.71	264.75	264.88	264.38	263.98	263.89	264.59	264.17	263.98	8
9	260.83 +	260.48	260.78	263.77	264.74 -	264.88	264.38	263.99	263.88	264.60	264.16	264.02	9
10	260.83 +	260.47	260.85	263.85	264.75	264.86	264.37	263.99	263.86	264.60	264.13	264.09	10
11	260.82	260.45	261.03	264.01	264.76	264.84	264.36	263.99	263.84	264.61 +	264.11	264.15	11
12	260.81	260.44	261.27	264.20	264.77	264.83	264.33	263.98	263.81	264.59	264.10	264.20	12
13	260.79	260.43	261.51	264.34	264.77	264.80	264.31	263.99	263.79	264.58	264.09	264.22	13
14	260.78	260.42	261.73	264.46	264.78	264.78	264.29	264.00	263.77	264.57	264.09	264.24 +	14
Max. +	260.76	260.41	261.91	264.57	264.80	264.75	264.27	264.02	263.74	264.56	264.09	264.24 +	15
16	260.74	260.40 -	262.06	264.65	264.80	264.72	264.25	264.03	263.72	264.55	264.07	264.24 +	16
17	260.73	260.40 -	262.20	264.72	264.79	264.69	264.24	264.03	263.70 -	264.54	264.04	264.23	17
18	260.71	260.43	262.32	264.78	264.79	264.67	264.22	264.04	263.71	264.53	264.03	264.23	18
19	260.69	260.47	262.43	264.82	264.81	264.66	264.19	264.04	263.81	264.52	264.02	264.22	19
20	260.70	260.52	262.52	264.85 +	264.84	264.66	264.15	264.05 +	263.93	264.50	264.02	264.20	20
Min. -													
21	260.71	260.56	262.61	264.85 +	264.85	264.65	264.12	264.05 +	264.02	264.47	264.04	264.19	21
22	260.73	260.59	262.69	264.85 +	264.87 +	264.63	264.09	264.04	264.08	264.46	264.03	264.17	22
23	260.75	260.62	262.77	264.85 +	264.85	264.61	264.07	264.03	264.12	264.45	264.02	264.16	23
24	260.75	260.64	262.84	264.85 +	264.84	264.60	264.05	264.00	264.15	264.43	264.01	264.15	24
25	260.75	260.66	262.90	264.84	264.83	264.58	264.03	263.98	264.17	264.42	264.00	264.14	25
26	260.74	260.67	262.97	264.83	264.82	264.56	263.99	263.96	264.19	264.40	263.99	264.13	26
27	260.73	260.68	263.03	264.83	264.81	264.55	263.96	263.94	264.22	264.37	263.98	264.12	27
28	260.71	260.69 +	263.09	264.83	264.81	264.54	263.94	263.94	264.24	264.36	263.98	264.11	28
29	260.69		263.14	264.83	264.81	264.53	263.92	263.94	264.26	264.34	263.96	264.10	29
30	260.67		263.20	264.84	264.82	264.51 -	263.92	263.95	264.27 +	264.33	263.95 -	264.08	30
31	260.65		263.25 +		264.82	264.82	263.91 -	263.95		264.32		264.06	31
Monatsmittel	260.73	260.53 -	261.89	264.32	264.80 +	264.73	264.22	263.98	263.96	264.48	264.09	264.10	
Maximum	260.83	260.70 -	263.28	264.87	264.87	264.90 +	264.51	264.06	264.28	264.61	264.32	264.25	
Datum	09.01	28.02	31.03	23.04	22.05	07.06	01.07	21.08	30.09	10.10	01.11	15.12	
Amplitude	0.26	0.30	2.61	1.58	0.14	0.39	0.61	0.16	0.59	0.34	0.38	0.34	
Jahr 2006	Mittel	263.50 m ü.M.		Maximum	264.90 (07.Jun)		Minimum	260.39 (17.Feb)		Amplitude	4.51 m		

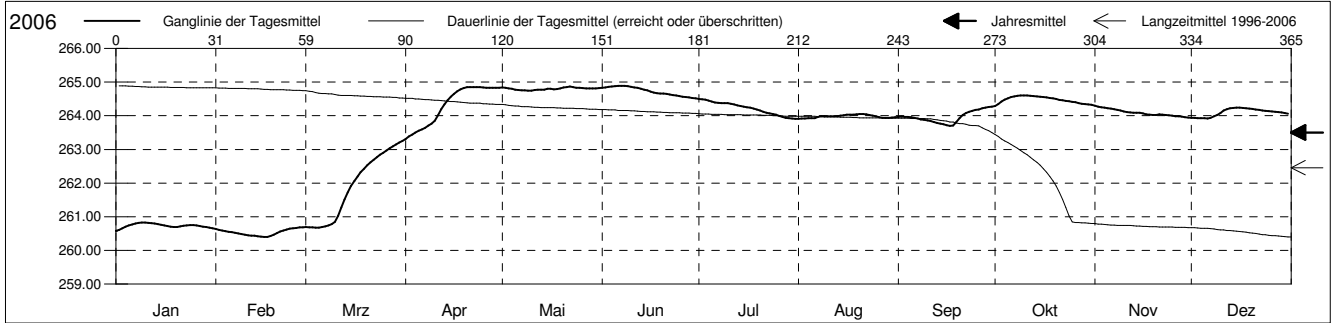

Periode	1996 - 2006												
Monatsmittel	262.54	262.44	262.72	262.82 +	262.81	262.63	262.45	262.32	262.06 -	262.09	262.27	262.35	
Maximum	264.72	264.11 -	264.72	265.07	265.02	264.90	264.61	264.41	264.28	264.61	265.19 +	265.17	
Jahr	2003	2003	2001	2001	2001	2006	1999	1999	2006	2006	2002	2002	
Minimum	260.57	260.39	260.67	261.42 +	261.33	261.21	260.98	259.15 -	260.77	260.73	260.66	259.15 -	
Jahr	2006	2006	2006	1997	2004	2004	2004	2005	2004	2004	1997	2004	
Amplitude	1.58	1.35	2.61	1.58	1.19	0.96	0.69	2.52	0.59 -	1.54	1.22	2.65 +	
Jahr	2004	1999	2006	2006	2002	2001	1996	2005	2006	2002	2002	2004	
Periode	Mittel	262.46 m ü.M.		Maximum	265.19 (27.Nov 2002)		Minimum	259.15 (08.Aug 2005)		Amplitude	6.04 m		

Darstellung der letzten 11 Jahre

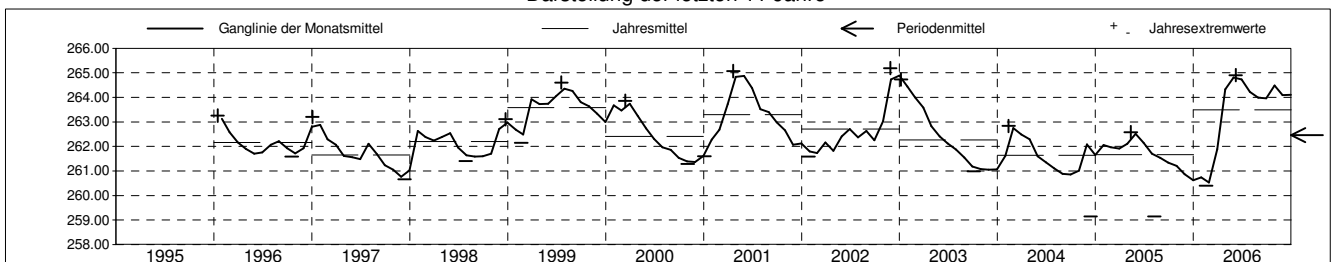

Grundwassertemperatur



Ergolzthal
 Pratteln 41.J.14 Löli - Remeli
 Abstichpunkt: 278.15 m ü.M.
 OK Terrain: 277.23 m ü.M.

Amt für Umweltschutz und Energie
Kanton Basel-Landschaft
 Koordinaten: 620545.75 / 264047.00

2006	Januar	Februar	März	April	Mai	Juni	Juli	August	September	Oktober	November	Dezember	
1	12.2 +	12.2 +	12.2 -	12.2 -	12.2 +	12.1 +	11.5 +	11.0	11.1 -	11.8 -	12.9 -	13.5 -	1
2	12.1 -	12.2 +	12.2 -	12.2 -	12.2 +	12.0	11.5 +	11.0	11.1 -	11.8 -	13.0	13.5 -	2
3	12.1 -	12.2 +	12.2 -	12.2 -	12.2 +	12.0	11.4	11.0	11.1 -	11.8 -	13.0	13.5 -	3
4	12.1 -	12.2 +	12.2 -	12.2 -	12.2 +	11.9	11.4	11.0	11.1 -	11.8 -	13.0	13.5 -	4
5	12.2 +	12.2 +	12.2 -	12.2 -	12.2 +	12.0	11.3	11.0	11.1 -	11.9	13.0	13.5 -	5
Tagesmittel													
6	12.1 -	12.2 +	12.2 -	12.2 -	12.2 +	11.9	11.3	11.0	11.1 -	11.9	13.1	13.5 -	6
7	12.1 -	12.2 +	12.3 +	12.2 -	12.2 +	11.9	11.3	10.9 -	11.2	12.0	13.1	13.5 -	7
8	12.1 -	12.2 +	12.2 -	12.2 -	12.2 +	11.9	11.3	11.0	11.2	12.1	13.1	13.6 +	8
9	12.2 +	12.2 +	12.2 -	12.2 -	12.2 +	11.9	11.3	11.0	11.2	12.1	13.1	13.5 -	9
10	12.2 +	12.2 +	12.2 -	12.2 -	12.2 +	11.9	11.2	11.0	11.2	12.1	13.1	13.5 -	10
11	12.1 -	12.2 +	12.2 -	12.2 -	12.2 +	11.9	11.2	11.0	11.2	12.2	13.2	13.6 +	11
12	12.2 +	12.2 +	12.2 -	12.2 -	12.2 +	11.8	11.2	11.0	11.2	12.2	13.2	13.6 +	12
13	12.2 +	12.2 +	12.2 -	12.2 -	12.2 +	11.8	11.2	11.0	11.2	12.2	13.3	13.6 +	13
14	12.2 +	12.2 +	12.3 +	12.2 -	12.2 +	11.8	11.2	11.0	11.3	12.3	13.3	13.6 +	14
15	12.2 +	12.2 +	12.2 -	12.2 -	12.2 +	11.8	11.2	11.0	11.3	12.3	13.3	13.6 +	15
Max. +													
16	12.2 +	12.2 +	12.2 -	12.2 -	12.2 +	11.7	11.2	11.0	11.3	12.3	13.3	13.6 +	16
17	12.2 +	12.2 +	12.2 -	12.3 +	12.1	11.7	11.1	11.0	11.3	12.4	13.3	13.6 +	17
18	12.2 +	12.2 +	12.2 -	12.2 -	12.1	11.7	11.1	11.0	11.3	12.4	13.3	13.6 +	18
19	12.2 +	12.2 +	12.2 -	12.2 -	12.2 +	11.7	11.1	11.0	11.4	12.4	13.4	13.6 +	19
20	12.2 +	12.2 +	12.2 -	12.2 -	12.1	11.7	11.1	11.0	11.4	12.5	13.4	13.6 +	20
Min. -													
21	12.2 +	12.2 +	12.2 -	12.2 -	12.1	11.7	11.1	11.0	11.4	12.5	13.4	13.6 +	21
22	12.2 +	12.2 +	12.2 -	12.2 -	12.1	11.6	11.1	11.0	11.5	12.6	13.4	13.6 +	22
23	12.2 +	12.2 +	12.2 -	12.2 -	12.1	11.6	11.1	11.0	11.5	12.6	13.4	13.6 +	23
24	12.2 +	12.2 +	12.2 -	12.2 -	12.1	11.6	11.0 -	11.0	11.6	12.7	13.4	13.6 +	24
25	12.2 +	12.2 +	12.2 -	12.2 -	12.1	11.6	11.1	11.0	11.6	12.7	13.4	13.6 +	25
26	12.2 +	12.2 +	12.2 -	12.2 -	12.1	11.6	11.0 -	11.0	11.6	12.7	13.5 +	13.6 +	26
27	12.2 +	12.2 +	12.2 -	12.2 -	12.1	11.5 -	11.0 -	11.0	11.6	12.8	13.5 +	13.6 +	27
28	12.2 +	12.2 +	12.2 -	12.2 -	12.1	11.5 -	11.0 -	11.1 +	11.7 +	12.8	13.5 +	13.6 +	28
29	12.2 +		12.2 -	12.2 -	12.1	11.5 -	11.0 -	11.1 +	11.7 +	12.9 +	13.5 +	13.6 +	29
30	12.2 +		12.2 -	12.2 -	12.1	11.5 -	11.0 -	11.1 +	11.7 +	12.9 +	13.5 +	13.6 +	30
31	12.2 +		12.2 -		12.0 -		11.0 -	11.1 +		12.9 +		13.6 +	31
Monatsmittel	12.2	12.2	12.2	12.2	12.2	11.8	11.2	11.0 -	11.3	12.3	13.3	13.6 +	
Maximum	12.2	12.2	12.3	12.3	12.2	12.1	11.5	11.1 -	11.7	12.9	13.5	13.6 +	
Datum	01.01	01.02	07.03	17.04	01.05	01.06	01.07	28.08	28.09	29.10	26.11	08.12	
Minimum	12.1	12.2	12.2	12.2	12.0	11.5	11.0	10.9 -	11.1	11.8	12.9	13.5 +	
Datum	02.01	01.02	01.03	01.04	31.05	27.06	24.07	07.08	01.09	01.10	01.11	01.12	
Amplitude	0.1	0.0 +	0.1	0.1	0.2	0.6	0.5	0.2	0.6	1.1	0.6	0.1	
Jahr 2006	Mittel	12.1 °C		Maximum	13.6 (08.Dez)		Minimum	10.9 (07.Aug)		Amplitude	2.7 °C		

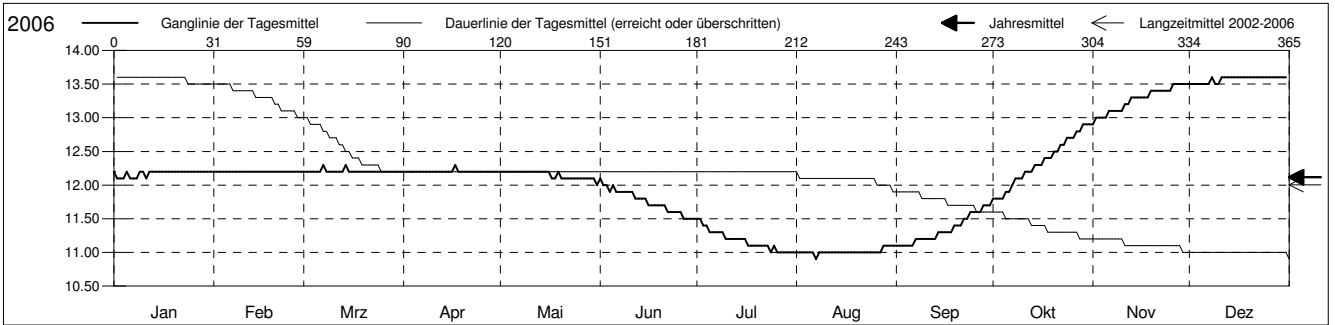

Periode	2002 - 2006												
Monatsmittel	12.4	12.4	12.3	12.2	12.0	11.7	11.4 -	11.4 -	11.6	11.9	12.3	12.5 +	
Maximum	12.7	12.6	12.6	12.6	12.5	12.3	12.1	12.0 -	12.0 -	12.9	13.5	13.6 +	
Jahr	2003	2003	2004	2004	2004	2004	2004	2004	2004	2006	2006	2006	
Minimum	12.1	12.2 +	11.9	11.5	10.9	10.5 -	10.5 -	10.5 -	10.8	11.3	11.8	12.1	
Jahr	2006	2006	2003	2003	2003	2003	2003	2003	2003	2003	2003	2004	
Amplitude	0.2 -	0.2 -	0.5	0.4	0.6	0.6	0.5	0.3	0.6	1.1 +	0.6	0.2 -	
Jahr	2004	2003	2003	2003	2003	2006	2006	2003	2006	2006	2006	2002	
Periode	Mittel	12.0 °C		Maximum	13.6 (08.Dez 2006)		Minimum	10.5 (29.Jun 2003)		Amplitude	3.1 °C		

Darstellung der letzten 5 Jahre

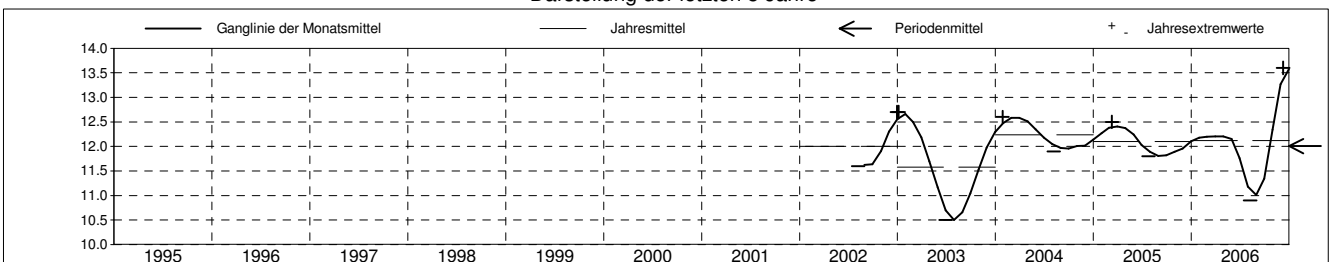

Grundwasserspiegel im Ergolztal

Station 41.J.14

Pratteln

Remeli / Löli

Koordinaten: 620'545.73 / 264'047.01

Messwerte: Grundwasserspiegel
Temperatur

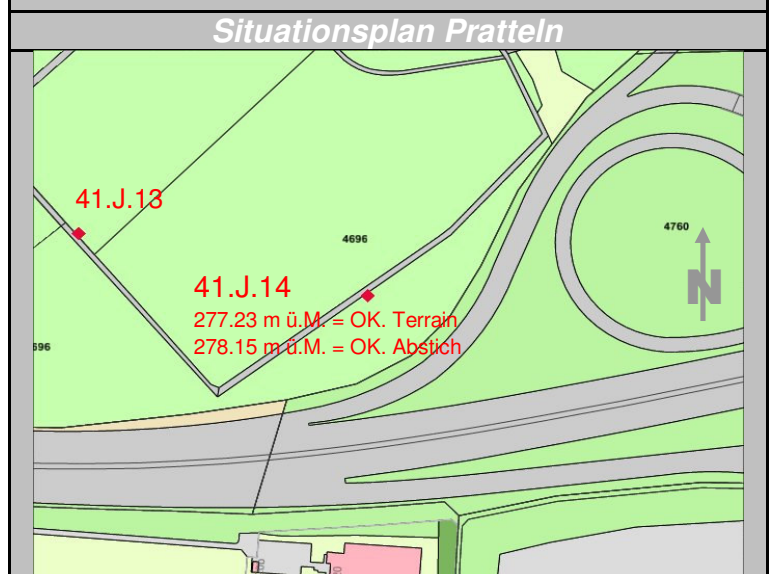
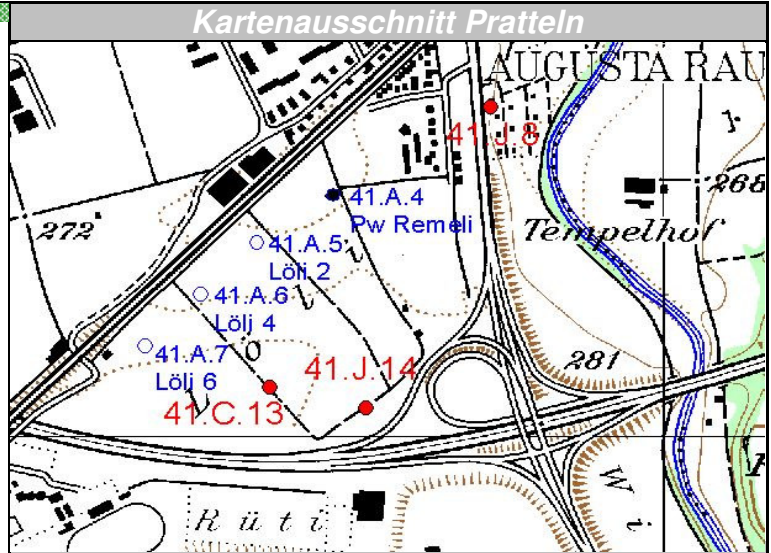
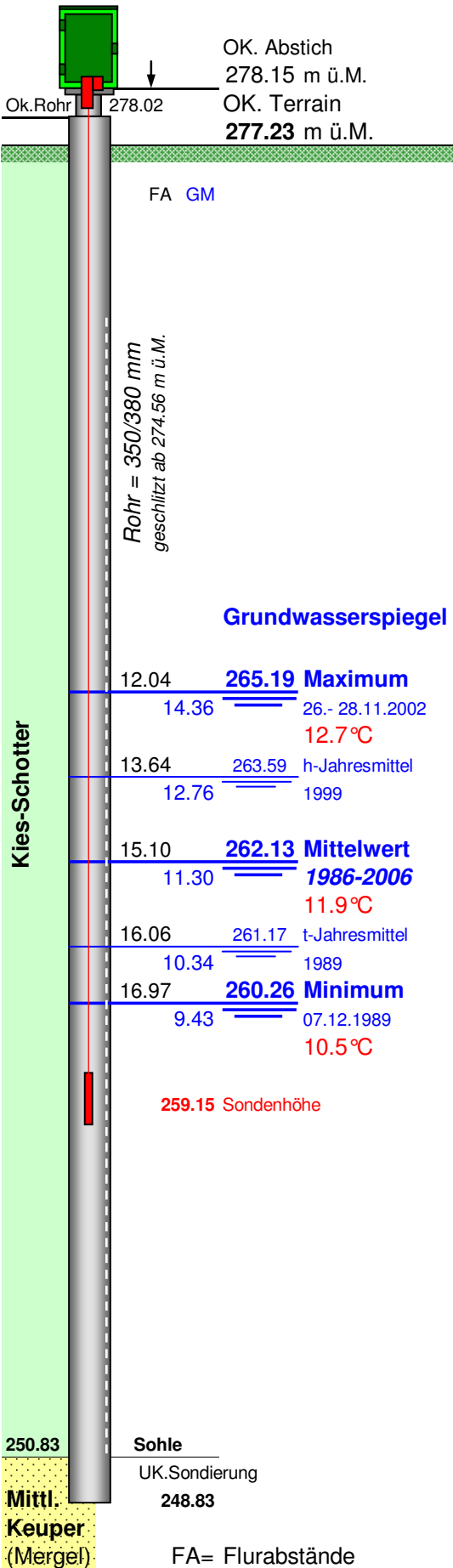

FA= Flurabstände
GM= Grundwassermächtigkeit in m