

Grundwasserstände



Diegtertal
 Tenniken 73.J.7 ob. Pumpwerk
 Abstichpunkt: 427.70 m ü.M.
 OK Terrain: 426.63 m ü.M.

Amt für Umweltschutz und Energie
Kanton Basel-Landschaft
 Koordinaten: 628002.00 / 253665.84

2004	Januar	Februar	März	April	Mai	Juni	Juli	August	September	Oktober	November	Dezember	
1	424.43	425.10 +	424.61	424.84 +	424.43	424.54	424.30	424.10	424.13 +	424.01 -	424.75 +	424.16	1
2	424.42	425.07	424.60	424.80	424.41	424.58	424.31	424.10	424.12	424.01 -	424.70	424.19	2
3	424.40	425.02	424.59 -	424.77	424.41	424.59	424.31	424.10	424.11	424.01 -	424.65	424.20	3
4	424.38	424.98	424.61	424.75	424.40	424.63	424.30	424.12	424.09	424.02	424.61	424.25	4
5	424.35	424.94	424.61	424.73	424.44	424.68	424.31	424.09	424.09	424.01 -	424.56	424.28	5
Tagesmittel													
6	424.33	424.93	424.77	424.71	424.44	424.70 +	424.34	424.06	424.07	424.01 -	424.52	424.30	6
7	424.32 -	424.92	424.88	424.71	424.41	424.66	424.33	424.06	424.05	424.02	424.48	424.29	7
8	424.34	424.89	424.85	424.68	424.38	424.62	424.35	424.05	424.04	424.01 -	424.44	424.27	8
9	424.52	424.87	424.81	424.66	424.45	424.58	424.36 +	424.04	424.03	424.03	424.40	424.26	9
10	424.71	424.87	424.80	424.64	424.47	424.55	424.31	424.06	424.03	424.07	424.37	424.24	10
11	424.80	424.86	424.79	424.63	424.43	424.54	424.29	424.12	424.03	424.15	424.35	424.23	11
12	424.93	424.84	424.78	424.62	424.40	424.54	424.29	424.10	424.07	424.10	424.32	424.21	12
13	425.18	424.83	424.77	424.61	424.38	424.51	424.28	424.11	424.08	424.08	424.31	424.19	13
14	425.31 +	424.83	424.85	424.58	424.36 -	424.49	424.28	424.11	424.05	424.07	424.29	424.18	14
15	425.17	424.81	424.88	424.58	424.36 -	424.46	424.25	424.07	424.05	424.24	424.27	424.16	15
Max. +													
16	425.10	424.80	424.87	424.56	424.37	424.43	424.23	423.99 -	424.04	424.51	424.25	424.15	16
17	425.14	424.79	424.85	424.54	424.56	424.40	424.22	424.02	424.03	424.51	424.23	424.13 -	17
18	425.16	424.78	424.83	424.54	424.56	424.38	424.22	424.08	424.02	424.49	424.22	424.16	18
19	425.14	424.76	424.81	424.53	424.55	424.37	424.23	424.09	424.02	424.48	424.21	424.25	19
20	425.22	424.74	424.79	424.51	424.55	424.37	424.23	424.15 +	424.01	424.65	424.18	424.41	20
Min. -													
21	425.26	424.73	424.77	424.50	424.55	424.35	424.22	424.15 +	424.01	424.66	424.17	424.39	21
22	425.16	424.73	424.75	424.49	424.60 +	424.34	424.23	424.13	424.00 -	424.65	424.16	424.37	22
23	425.09	424.74	424.73	424.48	424.60 +	424.34	424.20	424.10	424.00 -	424.60	424.15	424.34	23
24	425.04	424.69	424.79	424.46	424.57	424.32	424.18	424.10	424.03	424.56	424.14	424.36	24
25	425.00	424.67	425.00	424.45	424.53	424.30	424.17	424.10	424.04	424.50	424.13	424.37	25
26	424.97	424.67	425.03 +	424.43	424.53	424.28	424.17	424.13	424.04	424.63	424.12 -	424.48	26
27	424.93	424.65	424.97	424.42 -	424.52	424.28	424.17	424.13	424.03	425.19 +	424.12 -	424.62	27
28	424.90	424.63 -	424.92	424.43	424.53	424.27	424.15	424.11	424.01	425.07	424.13	424.69 +	28
29	424.87	424.63 -	424.91	424.43	424.52	424.27	424.14	424.11	424.01	424.96	424.14	424.65	29
30	424.85		424.89	424.43	424.51	424.26 -	424.12	424.14	424.01	424.87	424.16	424.60	30
31	424.87		424.87		424.51		424.11 -	424.15 +		424.80		424.55	31
Monatsmittel	424.85 +	424.82	424.81	424.58	424.48	424.45	424.24	424.10	424.05 -	424.39	424.32	424.32	
Maximum	425.37 +	425.11	425.05	424.86	424.62	424.71	424.38	424.17	424.15 -	425.23	424.77	424.70	
Datum	14.01	01.02	25.03	01.04	22.05	05.06	08.07	20.08	01.09	27.10	01.11	28.12	
Amplitude	1.06	0.49	0.48	0.45	0.27	0.46	0.29	0.21	0.19	1.25	0.67	0.60	
Jahr 2004	Mittel	424.45 m ü.M.		Maximum	425.37 (14.Jan)		Minimum	423.96 (16.Aug)		Amplitude	1.41 m		

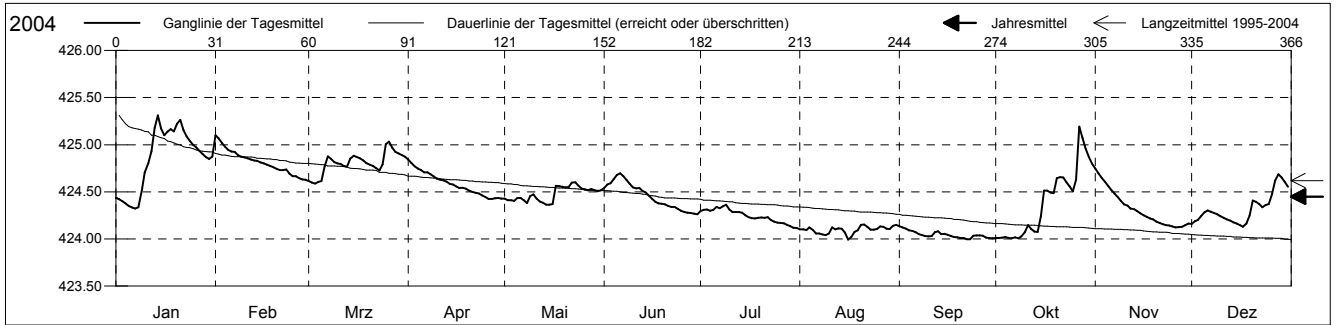

Periode	1995 - 2004												
Monatsmittel	424.78	424.77	424.80 +	424.66	424.64	424.56	424.56	424.41 -	424.44	424.53	424.61	424.66	
Maximum	425.64	426.12	425.75	425.46	426.27 +	426.05	425.46	425.08 -	425.34	425.52	425.66	425.86	
Jahr	1995	1999	2001	1998	1999	1995	1996	1995	2002	2002	1996	1997	
Minimum	424.29	424.26	424.24	424.32 +	424.29	424.17	424.09	423.62 -	423.89	423.98	424.02	424.06	
Jahr	2001	2001	2001	1997	1997	1997	2004	2003	2003	2004	1997	1997	
Amplitude	1.14	1.51	1.51	0.87 -	1.56	1.30	1.11	0.95	1.10	1.25	1.13	1.80 +	
Jahr	2001	1999	2001	1998	1999	1995	1996	2003	2002	2004	1996	1997	
Periode	Mittel	424.62 m ü.M.		Maximum	426.27 (12.Mai 1999)		Minimum	423.62 (28.Aug 2003)		Amplitude	2.65 m		

Darstellung der letzten 10 Jahre

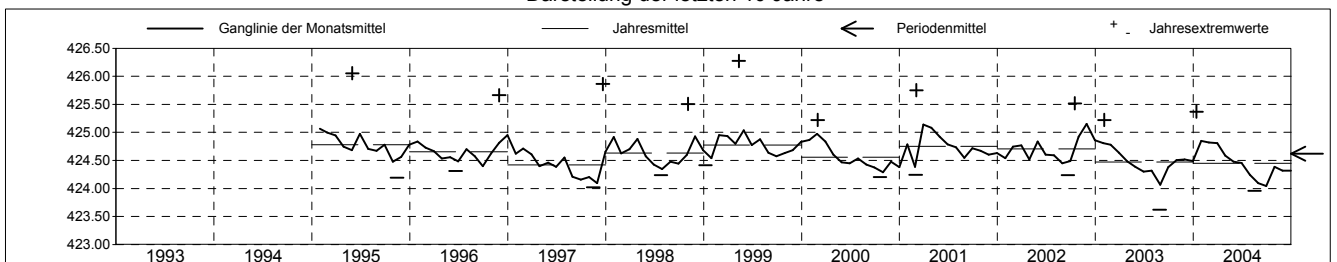

Grundwasserspiegel im Diegtertal

Station 73.J.7 Tenniken
Linnigraph

Oberhalb Pumpwerk

Koordinaten: 628'001.99 / 253'665.85

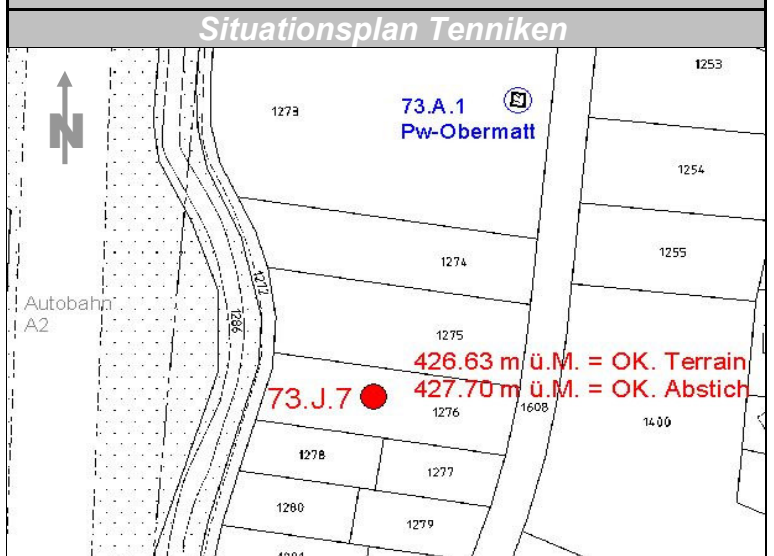
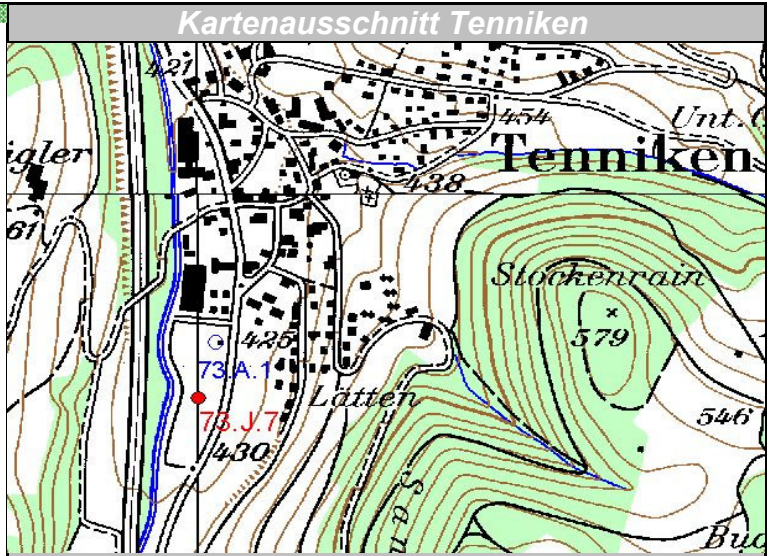
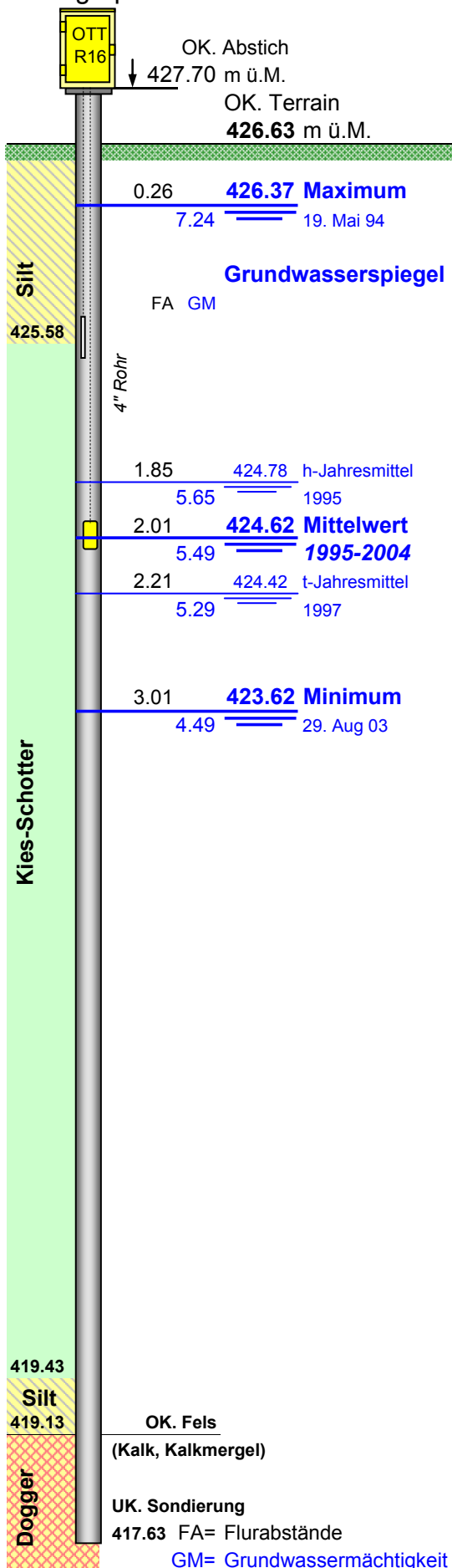

25.4.2002