

Grundwasserstände  
Niveaux piézométriques  
Livelli piezometrici

39.J.33 Liestal - Mess-stelle: Weiermatt

BL 251

Koordinaten  
Coordonnées  
Coordinate 621 564 / 260 339

OK Terrain  
Altitude terrain  
Altitudine terreno 302.72 m ü.M.  
m s.m.

Abstichpunkt  
Point de référence  
Punta di riferimento 303.72 m ü.M.  
m s.m.

2003	Jan./Janv. Genn.	Feb./Févr. Febbr.	März/Mars Marzo	April/Avr. Aprile	Mai/Mai Maggio	Juni/Juin Giugno	Juli/Juil. Luglio	Aug./Août Agosto	Sept./Sept. Sett.	Okt./Oct. Ott.	Nov./Nov. Nov.	Dez./Déc. Dic.	
1	292.44	292.33	292.32	292.16	292.12	292.13	292.01	292.01	291.97	291.88	292.01	292.08	1
2	292.53	292.33	292.41	292.21 +	292.08	292.14 +	292.04	291.96	291.93	291.89	292.01	292.05	2
3	292.61	292.47	292.47 +	292.20	292.11	292.14 +	292.04	291.95	291.92	291.89	291.98	292.03	3
4	292.69 +	292.72 +	292.40	292.17	292.09	292.12	292.04	291.94	291.91	291.94	291.97	292.01	4
5	292.67	292.61	292.36	292.15	292.08	292.12	292.04	291.93	291.91	292.04	291.96	292.01	5
6	292.61	292.55	292.35	292.15	292.07	292.14 +	292.03	291.92	291.91	292.00	291.95	291.99	6
7	292.55	292.50	292.40	292.14	292.06	292.10	292.01	291.92	291.92	292.09	291.94	291.97	7
8	292.52	292.48	292.35	292.13	292.05 -	292.10	292.00	291.91	292.01 +	292.21 +	291.93	291.95	8
9	292.47	292.46	292.33	292.13	292.08	292.11	291.99	291.92	291.97	292.15	291.93	291.95	9
10	292.44	292.43	292.32	292.13	292.10	292.09	291.99	291.92	291.94	292.10	291.92	291.95	10
11	292.41	292.41	292.41	292.12	292.06	292.08	291.98	291.91	291.99	292.05	291.91	291.93	11
12	292.39	292.40	292.31	292.11	292.17	292.08	291.97	291.90	291.98	292.03	291.90	291.94	12
13	292.37	292.39	292.30	292.11	292.14	292.08	291.97	291.90	291.96	292.01	291.94	291.94	13
14	292.35	292.37	292.27	292.11	292.14	292.07	291.97	291.92	291.98	292.00	291.95	292.00	14
15	292.35	292.35	292.26	292.10	292.09	292.06	291.96	291.90	291.95	291.98	291.94	292.05	15
16	292.32	292.34	292.24	292.10	292.08	292.06	291.96	291.90	291.94	291.97	291.93	292.04	16
17	292.31	292.33	292.24	292.10	292.06	292.05	291.98	291.94	291.94	291.96	292.00	292.02	17
18	292.30	292.31	292.22	292.09	292.06	292.04	291.96	291.94	291.93	291.96	292.02	292.03	18
19	292.29	292.30	292.21	292.09	292.08	292.03	291.96	291.92	291.92	291.95	291.99	292.00	19
20	292.29	292.29	292.21	292.09	292.13	292.03	291.95	291.90	291.92	291.97	291.98	292.01	20
21	292.31	292.28	292.20	292.09	292.11	292.03	292.01	291.90	291.92	292.02	291.95	292.17	21
22	292.33	292.27	292.19	292.10	292.10	292.03	291.98	291.90	291.91	292.01	291.95	292.23 +	22
23	292.33	292.27	292.18	292.08	292.12	292.02	291.96	291.89	291.91	291.97	291.94	292.16	23
24	292.40	292.27	292.17	292.08	292.10	292.01	291.96	291.89	291.90	291.98	291.95	292.12	24
25	292.36	292.27	292.17	292.08	292.09	292.00	291.95	291.88	291.89	291.96	291.94	292.10	25
26	292.33	292.28	292.16	292.08	292.08	291.99	291.95	291.87	291.87	291.96	291.93	292.07	26
27	292.33	292.28	292.16	292.09	292.10	291.99	291.96	291.88	291.87	291.95	291.94	292.06	27
28	292.36	292.29	292.16	292.08	292.15	291.98	292.01	291.88	291.87	291.94	292.12	292.07	28
29	292.38	292.29	292.16	292.08	292.25 +	291.98	291.97	291.92	291.89	291.94	292.15 +	292.08	29
30	292.37	292.27	292.16	292.09	292.18	291.98	291.95	291.93	291.88	291.97	292.09	292.07	30
31	292.35	292.27	292.19	292.10	292.15	292.05	292.05	292.04 +	291.97	291.97	292.05	292.05	31

Monatsmittel Moyennes mensuelles Media mensili	292.41 +	292.38	292.27	292.11	292.11	292.06	291.99	291.92 -	291.93	291.99	291.97	292.04	m ü.M. m s.m.
Maximum / Massime (Spitze / Pointe / Punta) Datum / Date / Data	292.76 02.	292.86 + 03.	292.51 03.	292.25 02.	292.37 28.	292.19 02.	292.10 31.	292.12 31.	292.02 - 08. 11.	292.28 07. 08.	292.19 29.	292.28 21.	m ü.M. m s.m.
Amplitude Amplitudine	0.47	0.60 +	0.36	0.19	0.33	0.22	0.17	0.25	0.16 -	0.42	0.29	0.36	m

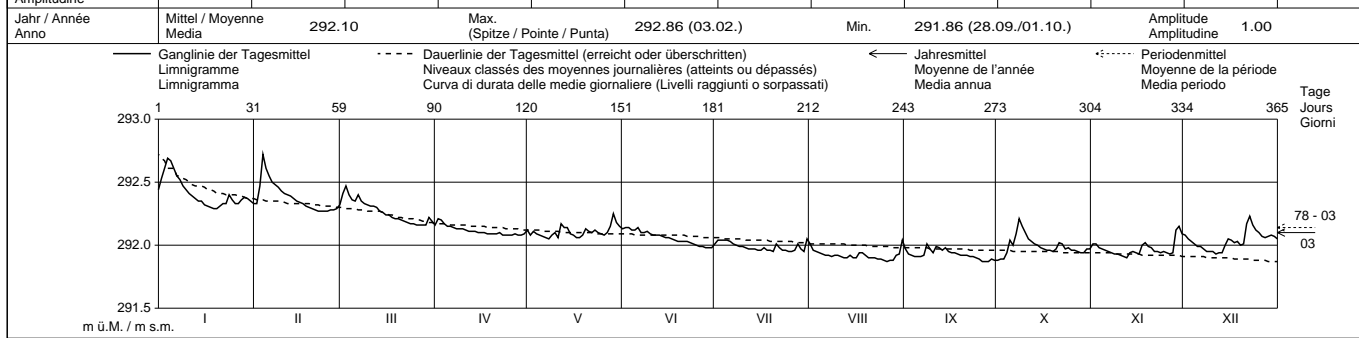

Periode / Période / Periodo	1978 - 2003													
Monatsmittel Moyennes mensuelles Media mensile	292.22	292.24	292.26 +	292.25	292.21	292.15	292.07	292.01	291.99 -	292.03	292.09	292.18	m ü.M. m s.m.	
Maximum / Massime (Spitze / Pointe / Punta) Jahr / Année / Anno	293.30 1982	293.92 1999	293.51 2001	293.25 1992	294.48 + 1999	293.57 1995	293.00 1999	292.90 - 1978	293.20 1987	293.40 2002	293.24 2002	293.49 1997	m ü.M. m s.m.	
Minimum / Minime Jahr / Année / Anno	291.82 1990	291.89 1992/1993	291.91 + 1993	291.87 1981	291.81 1981	291.82 1979	291.74 1979	291.70 1979	291.73 1989	291.70 1989	291.69 1978	291.68 - 1978	m ü.M. m s.m.	
Amplitude Amplitudine Jahr/Année/Anno	0.96 1982	1.79 1999	1.53 2001	1.13 1992	2.28 + 1999	1.41 1995	0.91 - 1996	1.08 1978	1.30 1987	1.15 2002	0.98 1995	1.60 1997	m	
Periode / Période / Periodo	Mittel / Moyenne Media	292.14			Max. (Spitze / Pointe / Punta)	294.48 (12.05.99)			Min.	291.68 (06.12.78/07.12.78)			Amplitude Amplitudine	2.80

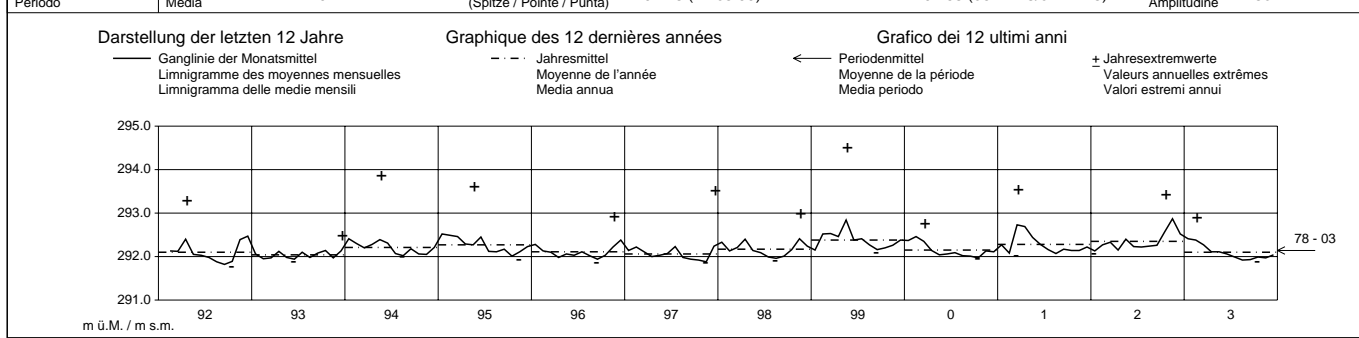

# Grundwasserspiegel im Ergolztal

Station 39.J.33 Liestal  
Limnigraph

Weiermatt  
Koordinaten: 621'563.97 / 260'339.45

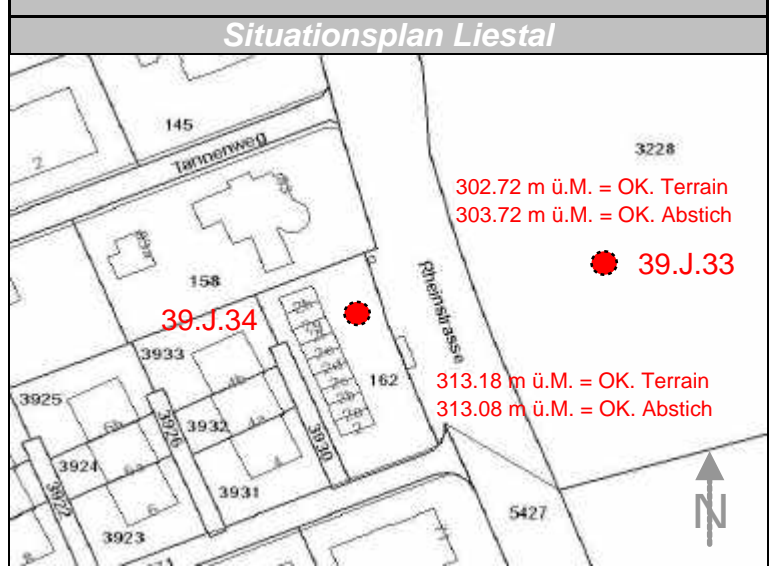
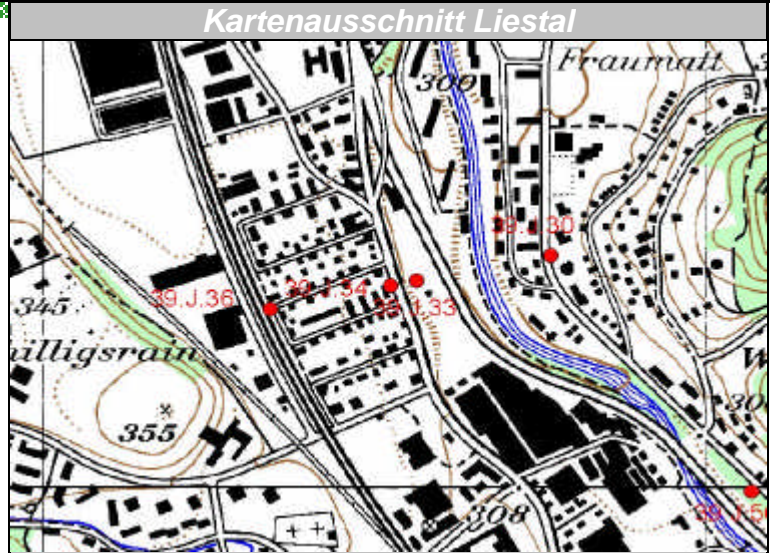
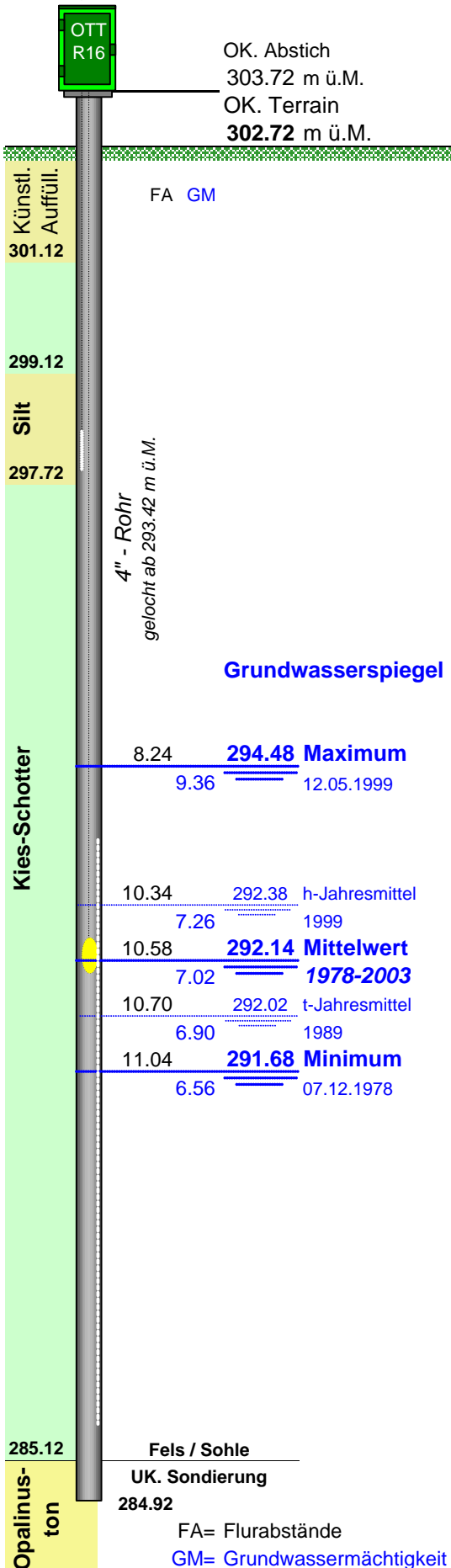

FA= Flurabstände  
GM= Grundwassermächtigkeit in m