

Grundwasserstände
Niveaux piézométriques
Livelli piezometrici

39.J.33 Liestal - Mess-stelle: Weiermatt

BL 251

Koordinaten
Coordonnées
Coordinate

621 564 / 260 339

OK Terrain
Altitude terrain
Altitudine terreno

302.72 m ü.M.
m s.m.
m s.m.

Abstichpunkt
Point de référence
Punta di riferimento

303.72 m ü.M.
m s.m.
m s.m.

2002	Jan./Janv. Genn.	Feb./Févr. Febr.	März/Mars Marzo	April/Avr. Aprile	Mai/Mai Maggio	Juni/Juin Giugno	Juli/Juil. Luglio	Aug./Août Agosto	Sept./Sept. Sett.	Okt./Oct. Ott.	Nov./Nov. Nov.	Dez./Déc. Dic.			
1	292.27	292.16	292.51	292.14	292.14	-	292.26	292.13	292.19	292.22	292.32	292.47	-	292.65	1
2	292.24	292.15	292.70 +	292.13	292.21		292.25	292.13	292.17	292.29	292.60	292.65		292.65	2
3	292.21	292.14	292.68	292.14	292.45		292.24	292.13	292.19	292.17	292.27	293.06		292.63	3
4	292.17	292.14	292.60	292.13	292.67		292.23	292.16	292.22	292.21	292.29	293.00		292.61	4
5	292.15	292.13	292.54	292.12	292.79 +		292.24	292.12	292.23	292.22	292.31	292.93		292.57	5
Moyennes journalières	292.13	292.16	292.48	292.12	292.65		292.28	292.14	292.22	292.17	292.52	292.84		292.55	6
7	292.12	292.20	292.43	292.11	292.56		292.32	292.15	292.28	292.18	292.59	292.82		292.53	7
8	292.11	292.20	292.39	292.11	292.50		292.30	292.12	292.28	292.21	292.49	292.81		292.50	8
9	292.10	292.22	292.37	292.10	292.45		292.27	292.11	292.23	292.17	292.42	292.89		292.48	9
10	292.09	292.29	292.34	292.10	292.42		292.30	292.14	292.32	292.26	292.37	293.03		292.45	10
11	292.08	292.26	292.32	292.09	292.40		292.28	292.11	292.54 +	292.27	292.33	293.11 +		292.43	11
12	292.08	292.23	292.31	292.08	292.40		292.25	292.09	292.50	292.22	292.31	293.02		292.41	12
13	292.08	292.21	292.29	292.17	292.61		292.24	292.15	292.40	292.19	292.30	292.91		292.39	13
14	292.07	292.20	292.27	292.25 +	292.50		292.23	292.21	292.34	292.17	292.31	292.89		292.38	14
m ü.M. m s.m.	292.07	292.18	292.26	292.22	292.43		292.22	292.15	292.31	292.16	292.47	293.11 +		292.38	15
16	292.06	292.18	292.24	292.19	292.40		292.22	292.30	292.28	292.15	292.70	293.08		292.42	16
17	292.05	292.17	292.23	292.17	292.38		292.21	292.53	292.26	292.14	293.25 +	293.08		292.76	17
18	292.04	292.16	292.22	292.16	292.36		292.20	292.58 +	292.25	292.13	293.02	292.97		292.64	18
19	292.05	292.15	292.25	292.15	292.34		292.19	292.45	292.23	292.13	292.84	292.91		292.57	19
20	292.05	292.23	292.30	292.15	292.32		292.19	292.37	292.22	292.16	292.74	292.85		292.50	20
21	292.10	292.24	292.26	292.15	292.31		292.20	292.33	292.21	292.14	292.68	292.79		292.53	21
22	292.11	292.37	292.29	292.14	292.28		292.21	292.30	292.20	292.13	292.79	292.80		292.57	22
23	292.09	292.47	292.29	292.13	292.27		292.18	292.27	292.18	292.20	292.73	292.76		292.59	23
+ Maximum Massime	292.12	292.63	292.26	292.13	292.32		292.27	292.25	292.17	292.66	292.73	292.83		292.56	24
25	292.15	292.49	292.23	292.12	292.30		292.23	292.23	292.17	292.70 +	292.77	292.85		292.52	25
- Minimum Minime	292.18	292.46	292.21	292.14	292.33		292.19	292.21	292.16	292.55	292.80	292.82		292.50	26
27	292.21	292.45	292.20	292.22	292.37		292.17	292.20	292.16	292.57	292.70	292.80		292.48	27
28	292.30 +	292.59 +	292.18	292.19	292.40		292.16	292.20	292.16	292.47	292.62	292.75		292.46	28
29	292.22	292.16	292.18	292.17	292.33		292.15	292.18	292.15	292.41	292.58	292.71		292.46	29
30	292.17	292.15	292.15	292.15	292.29		292.14	292.18	292.14	292.36	292.54	292.67		292.46	30
31	292.17	292.14	292.14	292.14	292.27		292.17	292.17	292.17	292.50	292.50	292.45		292.45	31

Monatsmittel Moyennes mensuelles Medie mensili	292.13 -	292.27	292.33	292.15	292.40	292.23	292.22	292.24	292.26	292.57	292.87 +	292.52	m ü.M. m s.m.
--	----------	--------	--------	--------	--------	--------	--------	--------	--------	--------	----------	--------	------------------

Maximum / Massime (Spitze / Pointe / Punta) Datum / Date / Data	292.35 28.	292.63 28.	292.74 02.	292.26 - 14.	292.92 04.	292.39 07.	292.73 17.	292.60 11.	292.85 24.	293.40 + 17.	293.24 09.	292.85 17.	m ü.M. m s.m.
---	---------------	---------------	---------------	-----------------	---------------	---------------	---------------	---------------	---------------	-----------------	---------------	---------------	------------------

Amplitude Amplitudine	0.31	0.50	0.60	0.18 -	0.78	0.25	0.65	0.48	0.73	1.15 +	0.79	0.48	m
--------------------------	------	------	------	--------	------	------	------	------	------	--------	------	------	---

Jahr / Année / Anno	Mittel / Moyenne Media	292.35			Max. (Spitze / Pointe / Punta)	293.40 (17.10.)			Min.	292.04 (18.01./20.01.)			Amplitude Amplitudine	1.36
---------------------	---------------------------	--------	--	--	-----------------------------------	-----------------	--	--	------	------------------------	--	--	--------------------------	------

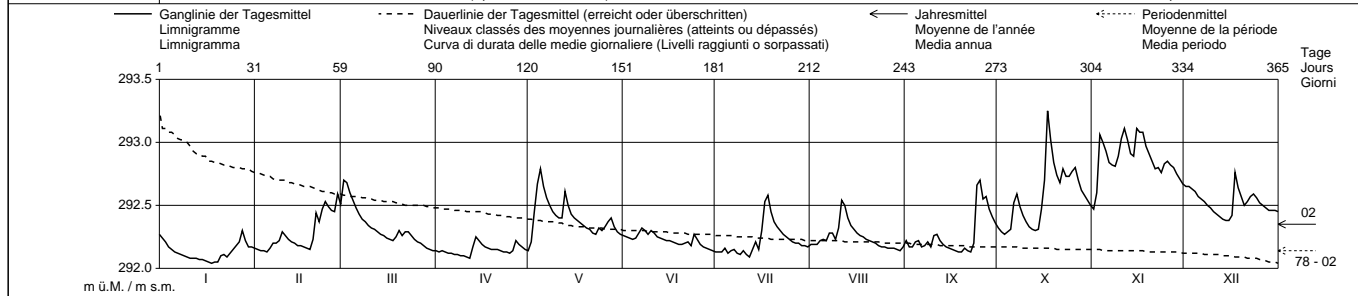

Periode / Période / Periodo 1978 - 2002

Monatsmittel Moyennes mensuelles Medie mensili	292.21	292.23	292.25	292.26 +	292.21	292.15	292.08	292.01	291.99 -	292.04	292.10	292.18	m ü.M. m s.m.
--	--------	--------	--------	----------	--------	--------	--------	--------	----------	--------	--------	--------	------------------

Maximum / Massime (Spitze / Pointe / Punta) Jahr / Année / Anno	293.30 1982	293.92 2001	293.51 2001	293.25 1992	294.48 + 1999	293.57 1995	293.00 1999	292.90 - 1978	293.20 1987	293.40 2002	293.24 2002	293.49 1997	m ü.M. m s.m.
---	----------------	----------------	----------------	----------------	------------------	----------------	----------------	------------------	----------------	----------------	----------------	----------------	------------------

Minimum / Minime Jahr / Année / Anno	291.82 1990	291.89 1992/1993	291.91 + 1993	291.87 1981	291.81 1981	291.82 1979	291.74 1979	291.70 1979	291.73 1989	291.70 1989	291.69 1978	291.68 - 1978	m ü.M. m s.m.
---	----------------	---------------------	------------------	----------------	----------------	----------------	----------------	----------------	----------------	----------------	----------------	------------------	------------------

Amplitude Amplitudine Jahr/Année/Anno	0.96 1982	1.79 1999	1.53 2001	1.13 1992	2.28 + 1999	1.41 1995	0.91 - 1996	1.08 1978	1.30 1987	1.15 2002	0.98 1995	1.60 1997	m
---	--------------	--------------	--------------	--------------	----------------	--------------	----------------	--------------	--------------	--------------	--------------	--------------	---

Periode / Période / Periodo	Mittel / Moyenne Media	292.14			Max. (Spitze / Pointe / Punta)	294.48 (12.05.99)			Min.	291.68 (06.12.78/07.12.78)			Amplitude Amplitudine	2.80
-----------------------------	---------------------------	--------	--	--	-----------------------------------	-------------------	--	--	------	----------------------------	--	--	--------------------------	------

Darstellung der letzten 12 Jahre Graphique des 12 dernières années Grafico dei 12 ultimi anni

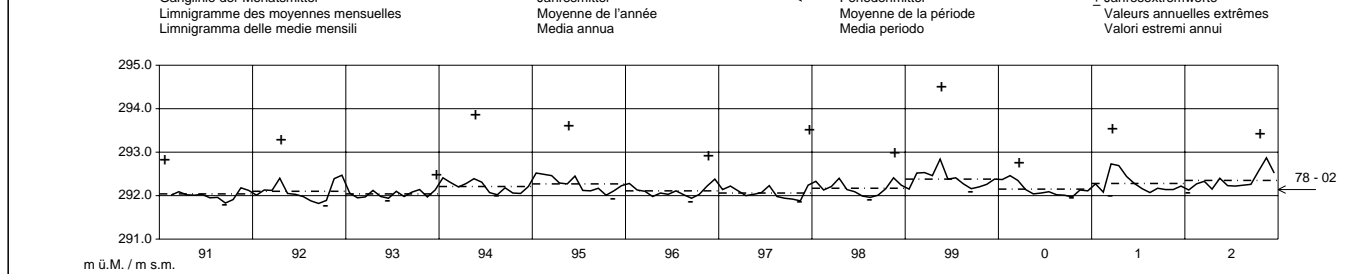

Grundwasserspiegel im Ergolztal

Station 39.J.33 Liestal
Limnigraph

Weiermatt
Koordinaten: 621'563.97 / 260'339.45

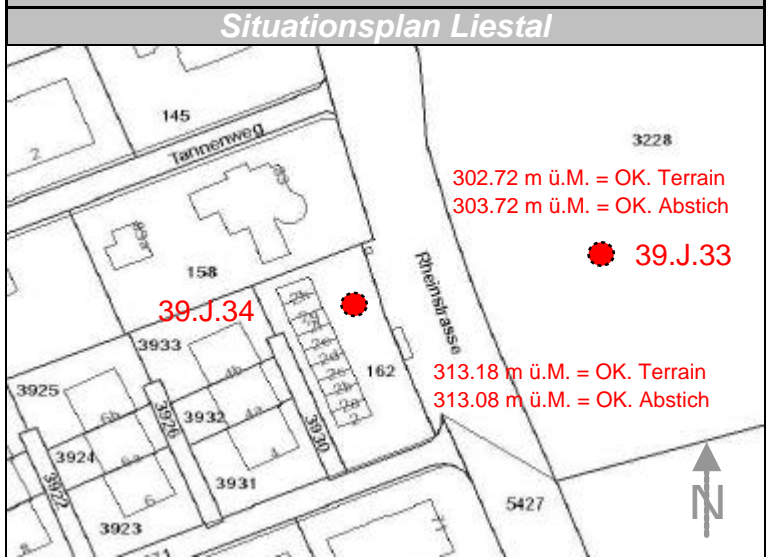
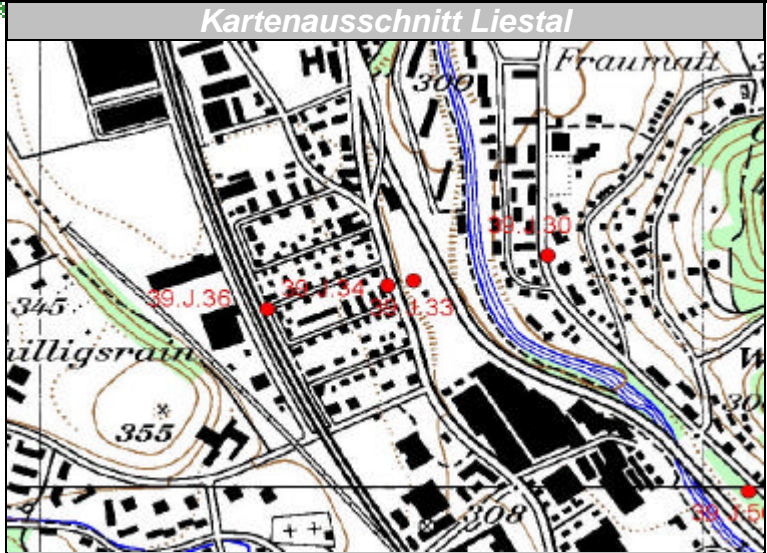
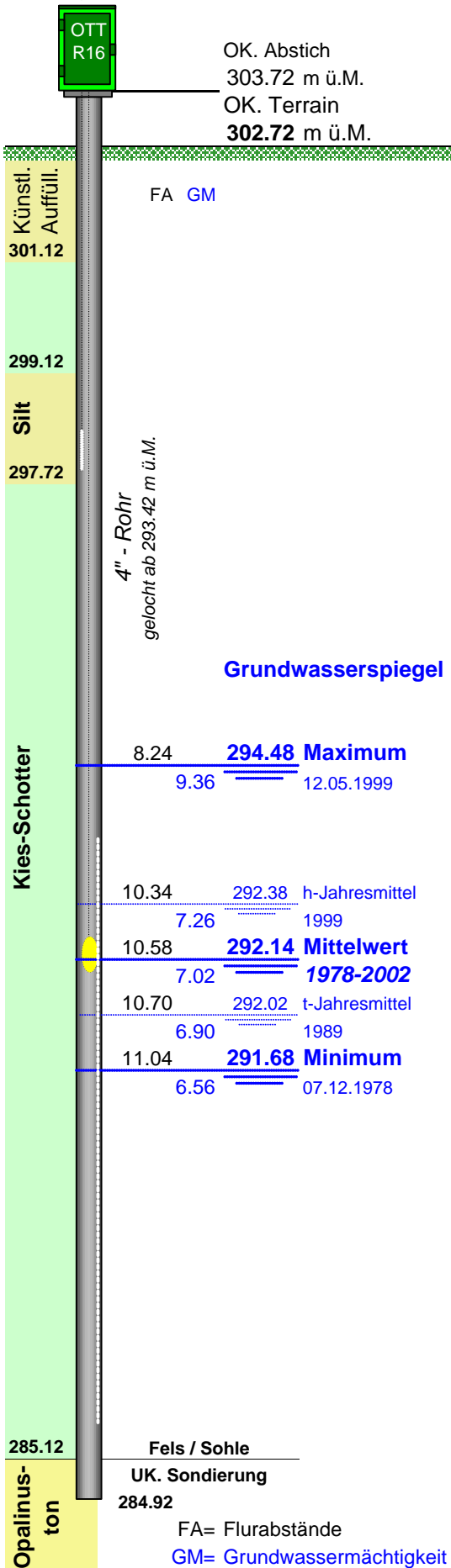

FA= Flurabstände
GM= Grundwassermächtigkeit in m