

Grundwasserstände  
Niveaux piézométriques  
Livelli piezometrici

41.J.8 Pratteln - Mess-stelle: Hausmatt

BL 255

Koordinaten 620 736 / 264 540 OK Terrain 268.41 m ü.M. Abstichpunkt 269.20 m ü.M.  
Coordonnées Altitude terrain m s.m. Point de référence m s.m.  
Coordinate Altitudine terreno m s.m. Punta di riferimento m s.m.

2001	Jan./Janv. Genn.	Feb./Févr. Febbr.	März/Mars Marzo	April/Avr. Aprile	Mai/Mai Maggio	Juni/Juin Giugno	Juli/Juil. Luglio	Aug./Août Agosto	Sept./Sept. Sett.	Okt./Oct. Ott.	Nov./Nov. Nov.	Dez./Déc. Dic.	
1	257.23	257.38	257.27	258.10	258.01	257.84	257.94	257.69	257.51	257.60	257.44	257.80	1
2	257.29	257.36	257.26	258.07	257.99	257.84	257.91	257.68	257.50	257.58	257.45	257.82	2
3	257.41	257.34	257.29	258.01	257.98	257.86	257.90	257.67	257.50	257.57	257.45	257.75	3
4	257.39	257.35	257.44	257.97	257.97	257.90	257.88	257.68	257.51	257.60	257.44	257.69	4
5	257.38	257.39	257.92	257.94	257.98	257.90	257.85	257.70	257.53	257.61	257.42	257.64	5
Moyennes journalières	257.45	257.38	258.12	257.94	258.11	257.87	257.84	257.70	257.56	257.58	257.42	257.61	6
7	257.69	257.37	258.00	257.95	258.12	257.89	257.81	257.70	257.56	257.58	257.41	257.59	7
8	257.74	257.36	257.92	257.99	258.07	257.88	257.81	257.69	257.57	257.59	257.45	257.56	8
9	257.69	257.34	257.88	257.99	258.03	257.96	257.80	257.70	257.62	257.59	257.50	257.53	9
10	257.63	257.31	257.88	258.20	257.99	258.12	257.80	257.70	257.73	257.57	257.48	257.51	10
11	257.57	257.30	257.86	258.45	257.96	258.30	257.78	257.70	257.71	257.55	257.46	257.51	11
12	257.52	257.31	257.93	258.47	257.93	258.33	257.75	257.70	257.68	257.55	257.45	257.50	12
13	257.49	257.32	258.28	258.39	257.90	258.27	257.75	257.68	257.66	257.53	257.44	257.47	13
14	257.45	257.31	258.51	258.28	257.89	258.22	257.77	257.65	257.68	257.51	257.43	257.44	14
15	257.42	257.31	258.57	258.19	257.90	258.17	257.78	257.63	257.69	257.50	257.41	257.43	15
16	257.40	257.30	258.49	258.20	257.93	258.14	258.00	257.61	257.68	257.47	257.40	257.42	16
17	257.38	257.29	258.39	258.28	257.97	258.16	258.16	257.60	257.76	257.47	257.40	257.40	17
18	257.36	257.28	258.29	258.29	258.14	258.17	258.08	257.59	257.86	257.47	257.40	257.39	18
19	257.35	257.28	258.21	258.24	258.22	258.21	258.02	257.59	257.81	257.46	257.39	257.39	19
20	257.34	257.28	258.16	258.19	258.22	258.24	257.96	257.59	257.76	257.45	257.38	257.38	20
21	257.34	257.28	258.20	258.13	258.15	258.23	257.94	257.60	257.78	257.44	257.36	257.38	21
22	257.35	257.29	258.43	258.08	258.08	258.19	257.94	257.59	257.81	257.43	257.36	257.38	22
23	257.35	257.30	258.48	258.07	258.02	258.15	257.91	257.58	257.82	257.43	257.36	257.36	23
24	257.35	257.30	258.42	258.03	257.98	258.09	257.91	257.56	257.83	257.43	257.35	257.35	24
25	257.43	257.29	258.36	258.04	257.96	258.05	257.88	257.55	257.81	257.47	257.36	257.36	25
26	257.47	257.29	258.33	258.15	257.94	258.02	257.84	257.54	257.76	257.52	257.37	257.36	26
27	257.49	257.31	258.29	258.18	257.90	258.00	257.81	257.54	257.73	257.51	257.39	257.35	27
28	257.47	257.29	258.23	258.14	257.88	258.01	257.78	257.53	257.70	257.48	257.39	257.35	28
29	257.43	257.29	258.21	258.10	257.86	258.01	257.75	257.52	257.66	257.46	257.40	257.40	29
30	257.42	257.29	258.20	258.06	257.86	257.99	257.73	257.51	257.62	257.45	257.49	257.61	30
31	257.41	257.29	258.14	258.06	257.85	257.99	257.71	257.51	257.62	257.45	257.49	257.60	31

Monatsmittel Moyennes mensuelles Medie mensili	257.44	257.32	258.10	258.14	257.99	258.07	257.86	257.62	257.68	257.51	257.42	257.49	m ü.M. m s.m.
Maximum / Massime (Spitze / Pointe / Punta) Datum / Date / Data	257.75 08.	257.40 01.	258.58 15.	258.49 11.	258.28 19.	258.36 12.	258.17 17.	257.70 11.12.	257.87 18.	257.62 04.	257.61 30.	257.86 01.	m ü.M. m s.m.
Amplitude Amplitudine	0.52	0.13	1.32	0.56	0.43	0.52	0.47	0.19	0.37	0.20	0.26	0.52	m
Jahr / Année Anno	Mittel / Moyenne Media 257.72		Max. (Spitze / Pointe / Punta) 258.58 (15.03.)		Min. 257.23 (01.01./02.01.)		Amplitude Amplitudine 1.35						

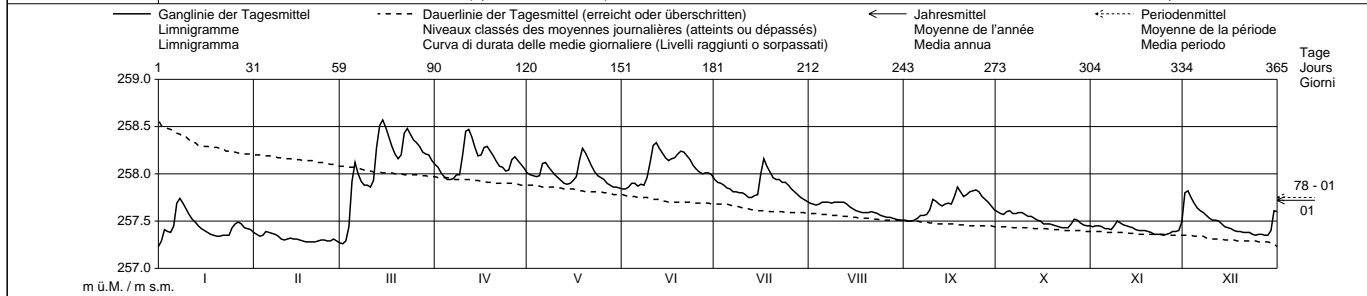

Periode / Période / Periodo	1978 – 2001												
Monatsmittel Moyennes mensuelles Medie mensili	257.74	257.74	257.79	257.85	257.88	257.97	257.89	257.72	257.60	257.56	257.57	257.63	m ü.M. m s.m.
Maximum / Massime (Spitze / Pointe / Punta) Jahr / Année / Anno	259.56 1982	259.30 1982	259.01 1978	259.00 1978	259.90 1999	258.99 1987	258.59 1987	258.55 1980	258.39 1987	258.71 1981	258.70 1981	259.46 1981	m ü.M. m s.m.
Minimum / Minime Jahr / Année / Anno	257.04 1990	257.09 1997	257.08 1997	257.02 1997	257.12 1996	257.17 1997	257.18 1996	257.16 1998	257.05 1997	256.94 1985	256.95 1997	256.95 1997	m ü.M. m s.m.
Amplitude Amplitudine Jahr/Année/Anno	0.88 1995	2.02 1999	1.32 2001	0.61 1986	2.20 1999	0.94 1995	0.76 1999	0.49 1987	0.71 1984	0.62 1981	0.86 1992	1.08 1995	m
Periode / Période Periodo	Mittel / Moyenne Media 257.75		Max. (Spitze / Pointe / Punta) 259.90 (13.05.99)		Min. 256.94 (18.10.85/19.10.85)		Amplitude Amplitudine 2.96						

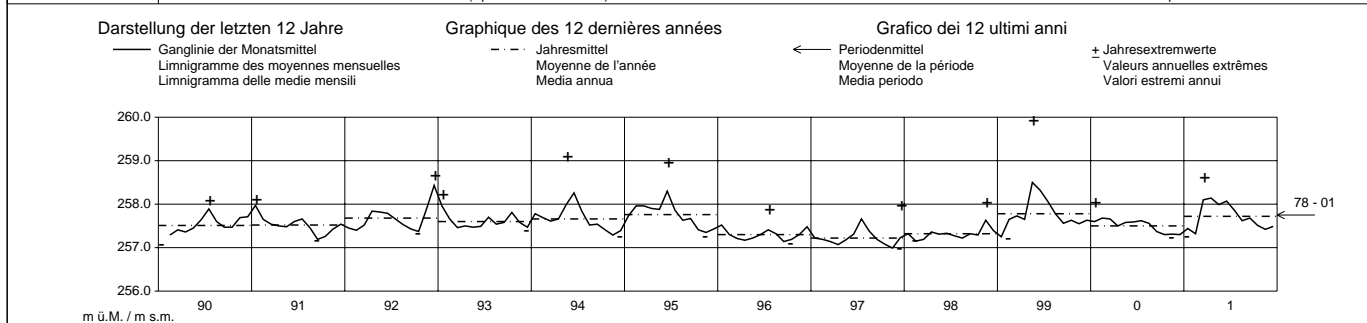

# Grundwasserspiegel im Ergolztal

Station 41.J.8  
Limnigraph

Pratteln

Hausmatt

Koordinaten: 620'736.22 / 264'539.94

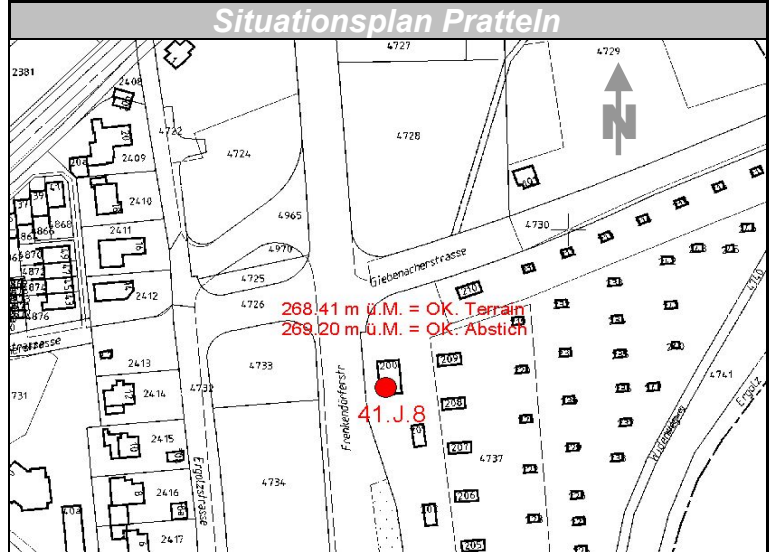
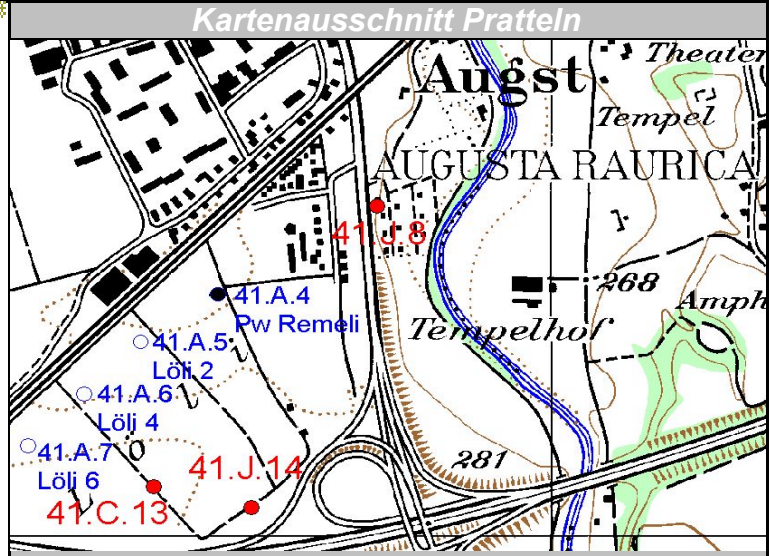
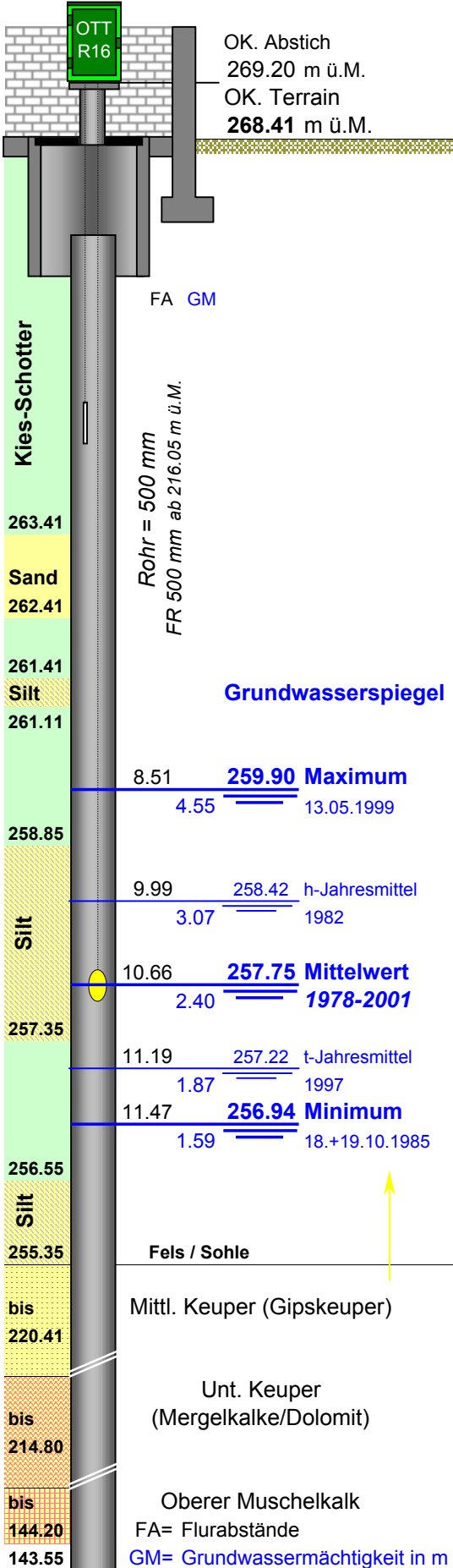

FA= Flurabstände  
GM= Grundwassermächtigkeit in m