

<b>Grundwasserstände</b>	<b>73. J. 7</b>	<b>Tenniken</b>	<b>Oberhalb Pumpwerk</b>	<b>Jahr 2001</b>
Koordinaten:	628 001.99 / 253 665.85	OK-Terrain:	426.63 m ü.M.	Abstichpunkt:
			427.70	m ü.M.

2001	Januar	Februar	März	April	Mai	Juni	Juli	August	September	Oktober	November	Dezember
1	424.30 -	424.61 +	424.27	424.98	424.95	424.78	424.73	424.56	424.49	424.76	424.67	425.08 + 1
2	424.55 -	424.51	424.26 -	424.96	424.93	424.78	424.70	424.56	424.47	424.75	424.66	424.97 2
3	424.84	424.49	424.33	424.93	424.91	424.80	424.68	424.57	424.46 -	424.72	424.65	424.89 3
4	424.81	424.52	425.23	424.91	424.89	424.80	424.65	424.60	424.48 -	424.80	424.63	424.84 4
Tagesmittel	424.79	424.52	425.55 +	424.90	424.91	424.76	424.63	424.60	424.49	424.78	424.60	424.81 5
6	425.08	424.49	425.32	424.88 -	425.07	424.75	424.62	424.58	424.47	424.76	424.59	424.78 6
7	425.36 +	424.44	425.22	424.92	425.01	424.75	424.69	424.57	424.50	424.77	424.60	424.76 7
8	425.21	424.44	425.17	424.91	424.96	424.75	424.73	424.60	424.52	424.79	424.62	424.74 8
9	425.10	424.44	425.19	424.97	424.94	424.88	424.72	424.64	424.60	424.81 +	424.72	424.71 9
interpol. x	425.03	424.42	425.15	425.36 +	424.91	424.99 +	424.70	424.66 +	424.60	424.81 +	424.70	424.69 10
11	424.97	424.40	425.12	425.28	424.89	424.99 +	424.67	424.63	424.57	424.75	424.67	424.66 11
12	424.91	424.39	425.31	425.20	424.87	424.91	424.67	424.61	424.56	424.73	424.64	424.64 12
13	424.89	424.39	425.45	425.13	424.86	424.87	424.70	424.60	424.54	424.71	424.61	424.61 13
14	424.84	424.38	425.42	425.07	424.87	424.83	424.70	424.59	424.58	424.68	424.62	424.57 14
Max. +	424.81	424.37	425.32	425.04	424.87	424.81	425.07 +	424.57	424.62	424.66	424.63	424.56 15
16	424.78	424.35	425.26	425.29	424.88	424.81	425.21 +	424.56	424.62	424.63	424.62	424.52 16
17	424.74	424.34	425.21	425.28	424.98	424.80	425.07	424.55	424.90	424.61	424.60	424.49 17
18	424.72	424.33	425.18	425.21	425.24 +	424.79	424.95	424.52	425.06	424.57	424.58	424.47 18
19	424.70	424.33	425.16	425.16	425.15	424.77	424.85	424.51	424.93	424.55	424.55	424.46 19
Min. -	424.67	424.32	425.25	425.13	425.06	424.76	424.80	424.54	424.86	424.54	424.53	424.45 20
21	424.64	424.32	425.50	425.09	425.01	424.74	424.77	424.53	424.95	424.54	424.51	424.45 21
22	424.61	424.32	425.34	425.10	424.96	424.72	424.75	424.51	424.95	424.52	424.50	424.44 22
23	424.61	424.31	425.25	425.13	424.91	424.70	424.74	424.49	424.94	424.52 -	424.49	424.42 23
24	424.62	424.31	425.20	425.09	424.88	424.68 -	424.70	424.49	425.11 +	424.56	424.47 -	424.43 24
25	424.70	424.29	425.17	425.16	424.88	424.67 -	424.68	424.48	425.05	424.62	424.49 -	424.41 25
26	424.72	424.28	425.14	425.20	424.86	424.68 -	424.65	424.47	424.96	424.66	424.50	424.41 26
27	424.72	424.27 -	425.12	425.13	424.85	424.77	424.63	424.47	424.88	424.65	424.51	424.40 - 27
28	424.70	424.27 -	425.10	425.06	424.83	424.80	424.61	424.47	424.83	424.63	424.53	424.45 28
29	424.68		425.08	425.03	424.81	424.75	424.60	424.47 -	424.80	424.63	424.59	424.72 29
30	424.64		425.05	425.00	424.79	424.75	424.59	424.47	424.78	424.62	424.94 +	424.95 30
31	424.64		425.01		424.78 -		424.57 -	424.48		424.61		424.85 31
Monatsmittel	424.79	424.39 -	425.14 +	425.08	424.93	424.79	424.74	424.55	424.72	424.67	424.60	424.63
Maximum	425.43	424.64 -	425.75 +	425.39	425.29	425.01	425.27	424.68	425.15	424.82	425.12	425.12
Datum	7.1.	1.2.	5.3.	10.4.	18.5.	10.+11.6.	15.+16.7.	10.8.	24.9.	9.+10.10.	30.11.	1.12.
Amplitude *	1.14	0.38	1.51 +	0.51	0.51	0.34	0.72	0.23 -	0.70	0.32	0.66	0.74
Jahr 2001	Mittel	424.75	m ü.M.	Maximum	425.75	(5. März 01)	Minimum	424.24	(2. März 2001)	Amplitude*	1.51	m

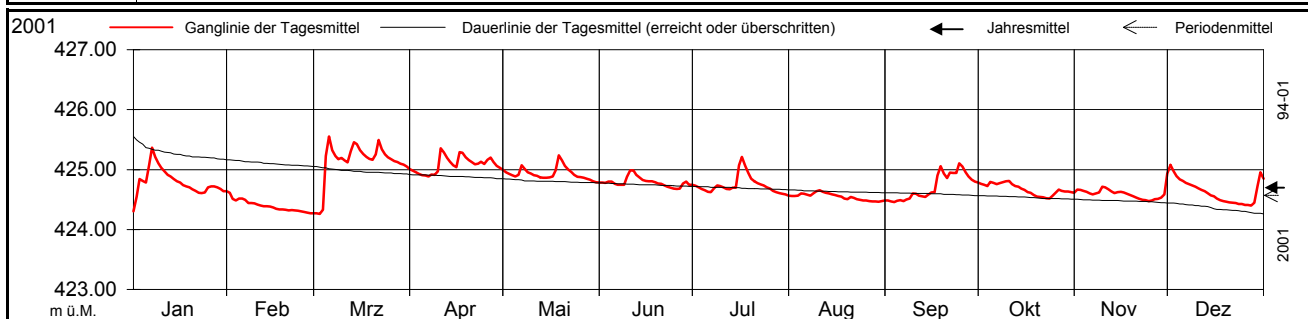

Periode 1994 - 2001												
Monatsmittel	424.82 +	424.77	424.81	424.73	424.69	424.65	424.62	424.49	424.52	424.48 -	424.56	424.69
Maximum	425.64	426.12	425.75	425.46	426.37 +	426.06	425.46	425.09 -	425.18	425.28	425.66	425.86
Jahr	1995	1999	2001	1998	1994	1995	1996	1995	1995	1996	1996	1997
Minimum	424.29	424.26	424.24	424.32 +	424.29	424.17	424.24	424.07	424.09	424.10	424.02 -	424.05
Jahr	2001	2001	2001	1997	1997	1997	1998	1997	1997	1997	1997	1997
Amplitude *	1.14	1.51	1.51	0.87	2.00 +	1.31	1.11	0.57 -	0.70	0.95	1.12	1.81
Jahr	2001	1999	2001	1998	1994	1995	1996	1995	2001	1996	1996	1997
Periode	Mittel	424.65	m ü.M.	Maximum	426.37	(19. Mai 94)	Minimum	424.02	(16. Nov. 1997)	Amplitude*	2.35	m

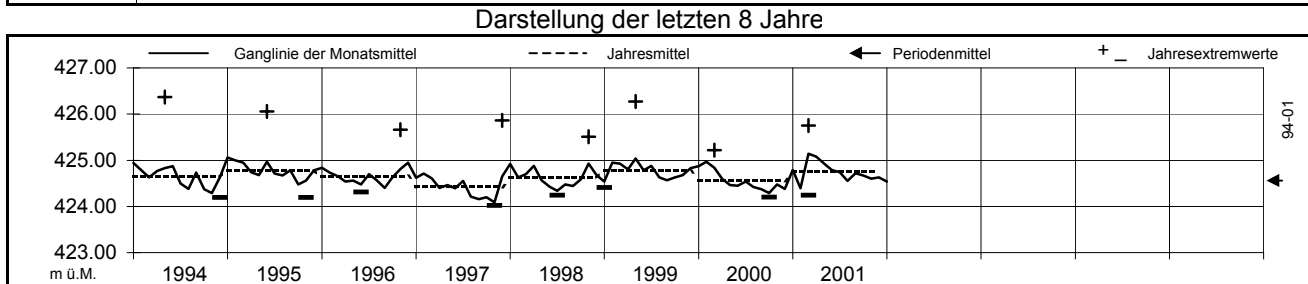

\* Die Amplituden sind aufgrund von Extremwerten berechnet

# Grundwasserspiegel im Diegtertal

Station 73.J.7 Tenniken  
Linnigraph

Oberhalb Pumpwerk

Koordinaten: 628'001.99 / 253'665.85

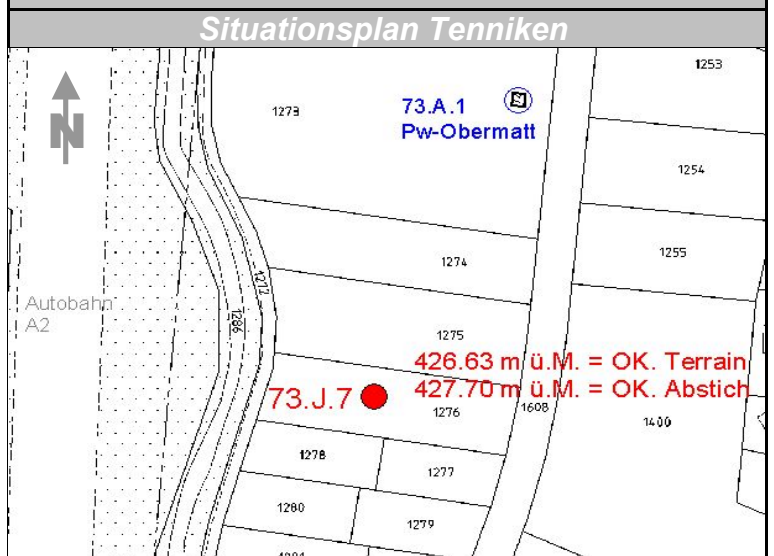
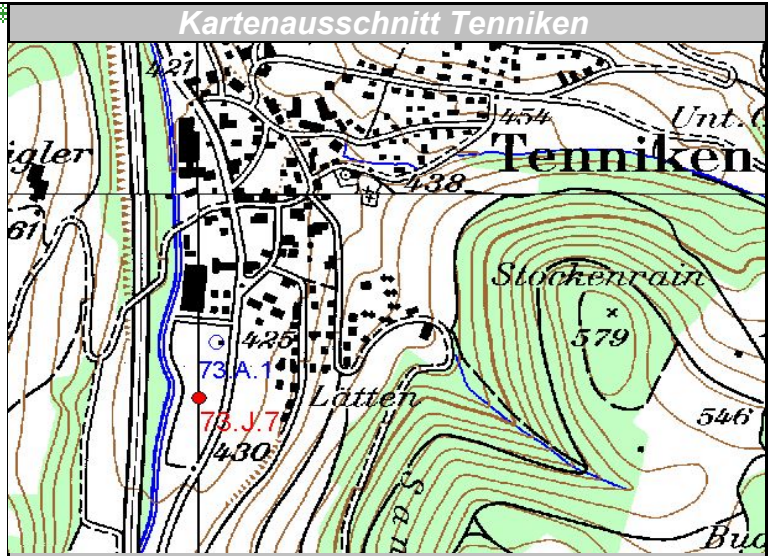
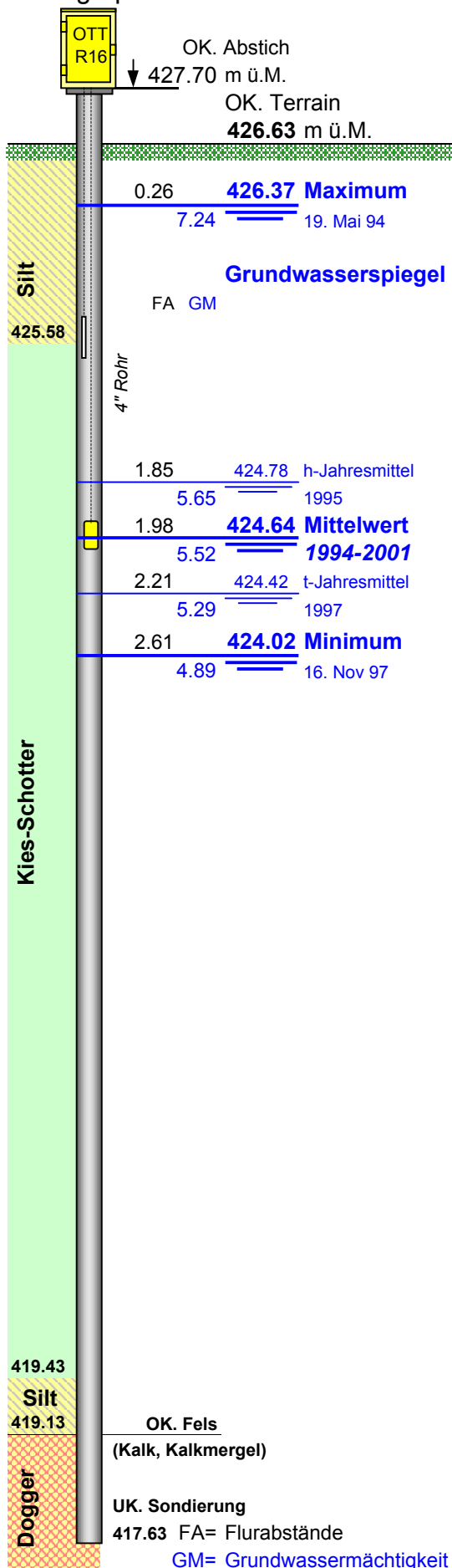

25.4.2002